

NOV 21 1997

LIBER

2 PAGE 131

RECEIVED FOR RECORD

97 SEP -9 AM 8:57

COMMISSION

REMONUMENTATION
LAND CORNER RECORDATION CERTIFICATE
Filing Requirement of Act 74, Mich. P.A. 1970

LIBER NO. 2 PAGE NO. 131
ESTHER LEE
REGISTER OF DEEDS
SANILAC CO., MICHIGAN

For corners in

Sanilac (County)	Located In:	Corner Code #
1. Public Land Survey	T11N R13E	E - 13
	T R	
	T R	
	T R	
2. Property Controlling in Section	S T R	<u>Sec. 2</u>
	S T R	
3. Miscellaneous Property in Sec.	S T R	
	S T R	

Register of Deeds Stamp & File Number

4. Lot No. _____, Recorded Plat _____
5. Private Claims _____

I, John A Milletics, in a field survey on June 21, 1997 do hereby state that under requirements of P.A. 74, Michigan P.A. of 1970, the corner points mentioned in lines 1 and 2 above were in conformance with regulations and rules therefore as required in the current manual of survey instructions of the United States Department of the Interior, Bureau of Land Management or by a decree of a Court of Law and/or that the corner points mentioned in lines 3, 4 and 5 above were in conformance with the rules of the Michigan Board of Land Surveyors or by a Decree of a Court of Law; established, re-established, monumented, recovered, found as expressed below:

NOTE: Not more than 2 corners, all in the same town and range, may be recorded on this certificate.

	A	B	C	D	E	F	G	H	I	J	K	L	M
1													
2	6		5		4		3		2		1		
3													
4	7		8		9		10		11		12		
5													
6	18		17		16		15		14		13		
7													
8	19		20		21		22		23		24		
9													
10	30		29		28		27		26		25		
11													
12	31		32		33		34		35		36		
13													

A. Description of original monument and accessories and/or subsequent restoration:

- E - 13
- GLO Notes
- Black Ash 20 N76°E 47
- Birch 11 N51°W 18

APPROVED PEER BOARD MEETING

Aug 18, 1997 JM

B. Description of corner evidence found and/or method applied in restoring or reestablishing corner:

- E - 13
- SW Cor Section 33 T11N-R13E
- Found Monu Box in Place - removed by Sanilac County Road Comm. during reconstruction of road - REPLACED using Act 74 as recorded in Liber 1 Page 398

C. Description of monument for corner and accessories established to perpetuate locating the position of the corner:

- E - 13
- SW Corner Section 33 T11N-R13E
- MONU BOX with iron and cap
- West 20.05 feet to the NE Cor Section 4 (MONU BOX)
- N45°E 66.40 feet to a nail in a Power Pole
- S45°E 47.54 to a Riser Box
- S60°W 87.44 feet to a nail in a Power Pole
- East 2653.64 feet to the S 1/4 Cor Section 33

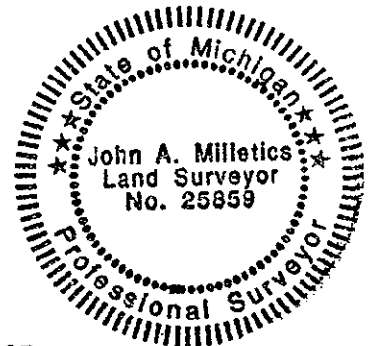

Signed by [Signature]

Date Aug 11, 1997

Surveyor's Michigan License No. 25859