

JAN 19 2000

LIBER

2 PAGE 331

1999 REMONUMENTATION PROGRAM
LAND CORNER RECORDATION CERTIFICATE
Filing Requirement of Act 74, Mich. P.A. 1970

RECEIVED FOR RECORD

99 NOV 30 AM 9:03

SECTION

For corners in

LIBER NO. 2 PAGE NO. 331
MICHELE VANNORMAN
REGISTER OF DEEDS
SANILAC CO., MICHIGAN

SANILAC

(County)

Located In:

Corner Code #

- 1. Public Land Survey T 12 NR 14 E A-1
- T R
- T R
- T R
- 2. Property Controlling S T R
- in Section S T R
- 3. Miscellaneous S T R
- Property in Sec. S T R

Register of Deeds Stamp & File Number

- 4. Lot No. _____, Recorded Plat _____
- 5. Private Claims _____

I, John A. Millett, in a field survey on Aug. 2, 19 99 do hereby state that under requirements of P.A. 74, Michigan P.A. of 1970, the corner points mentioned in lines 1 and 2 above were in conformance with regulations and rules therefore as required in the current manual of survey instructions of the United States Department of the Interior, Bureau of Land Management or by a decree of a Court of Law and /or that the corner points mentioned in lines 3, 4 and 5 above were in conformance with the rules of the Michigan Board of Land Surveyors or by a Decree of a Court of Law; established, re-established, monumented, recovered, found as expressed below:

NOTE: Not more than 2 corners, all in the same town and range, may be recorded on this certificate.

A	B	C	D	E	F	G	H	I	J	K	L	M
1												
2	6	5	4	3	2	1						
3												
4	7	8	9	10	11	12						
5												
6	18	17	16	15	14	13						
7												
8	19	20	21	22	23	24						
9												
10	30	29	28	27	26	25						
11												
12	31	32	33	34	35	36						
13												

A. Description of original monument and accessories and/or subsequent restoration:

- A-1 Hemlock 11 S79W 30; Birch 8 N87E 3.1/2
- Old Survey Liber - None
- L.C.R.C. - Liber 2 Page 94
- Act 132 - Liber 4 Page 160

B. Description of corner evidence found and/or method applied in restoring or reestablishing corner:

- A-1
- NW Corner Section 6, T12N-R14E
- Found 1/2" Iron Bar in gravel Road Bed
- South 2883.05 feet to the W 1/4 Corner
- Accepted as best evidence

APPROVED PEER BOARD MEETING
NOV 19, 1999

C. Description of monument for corner and accessories established to perpetuate locating the position of the corner:

- A - 1
- NW Corner Section 6 T12N-R14E
- 1/2" Iron Bar in gravel road bed
- South 2883.05 feet to the W 1/4 Corner
- S30°W 21.03 feet to a nail in a Twin Pine
- N45°E 21.40 feet to the west end of a 12" CMP
- N60°E 48.50 feet to the East end of a 12" CMP
- S60°E 80.60 feet to a nail in a Guard Rail Post

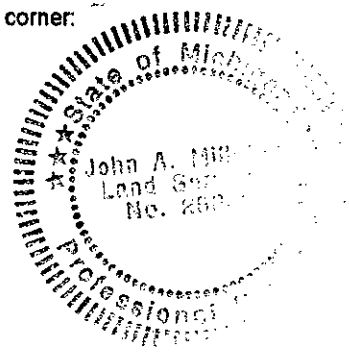

Signed by John A. Millett
Surveyor's Michigan License No. 25859

Date 11-15-99