

SEP 01 1998

SECTION  
REMONUMENTATION

LIBER

2 PAGE 198

LAND CORNER RECORDATION CERTIFICATE  
Filing Requirement of Act 74, Mich. P.A. 1970

RECEIVED FOR RECORD

98 JUN 30 AM 10: 21

LIBER NO. 2 PAGE NO. 198

MICHELE VANNORMAN  
REGISTER OF DEEDS  
SANILAC CO., MICHIGAN

For corners in

Sanilac (County)	Located in:	Corner Code #
1. Public Land Survey	T <u>13NR</u> R <u>12E</u>	A-9
	T _____ R _____	_____
	T _____ R _____	_____
	T _____ R _____	_____
2. Property Controlling in Section	S _____ T _____ R _____	_____
	S _____ T _____ R _____	_____
3. Miscellaneous Property in Sec.	S _____ T _____ R _____	_____
	S _____ T _____ R _____	_____

Register of Deeds Stamp & File Number

4. Lot No. \_\_\_\_\_, Recorded Plat \_\_\_\_\_  
5. Private Claims \_\_\_\_\_

John A. Milletics, in a field survey on May 1, 1998 do hereby state that under requirements of P.A. 74, Michigan P.A. of 1970, the corner points mentioned in lines 1 and 2 above were in conformance with regulations and rules therefore as required in the current manual of survey instructions of the United States Department of the Interior, Bureau of Land Management or by a decree of a Court of Law and /or that the corner points mentioned in lines 3, 4 and 5 above were in conformance with the rules of the Michigan Board of Land Surveyors or by a Decree of a Court of Law, established, re-established, monumented, recovered, found as expressed below:

NOTE: Not more than 2 corners, all in the same town and range, may be recorded on this certificate.

	A	B	C	D	E	F	G	H	I	J	K	L
1												
2		6		5		4		3		2		1
3												
4		7		8		9		10		11		12
5												
6		18		17		16		15		14		13
7												
8		19		20		21		22		23		24
9												
10		30		29		28		27		26		25
11												
12		31		32		33		34		35		36
13												

A. Description of original monument and accessories and/or subsequent restoration:

1834 GLO notes-Harvey Parke, D.S. -Set post corner Secs. 24 & 25-Beech 7 N79W 20; Hemlock 34 S40W 53

Old Survey Liber F.F. Rogers  
Old Survey Liber M.E Ward  
Act 132 Liber 2 Page 130-131  
Liber 4 Page 691-692

B. Description of corner evidence found and/or method applied in restoring or reestablishing corner:

A-9

Found Concrete Monument with Brass Cap  
North W 1/4 Section 19  
South W 1/4 Section 30

APPROVED PEER BOARD MEETING  
June 6, 1998 *gm*

C. Description of monument for corner and accessories established to perpetuate locating the position of the corner:

A-9

Concrete Monument with 2" Brass Cap stamped M9 T13N-R11E  
N30°E, 52.94' -T.C. Re-mon. tag in West face of 40" Maple  
S45°E, 83.01' -T.C. Re-mon. tag in Southwest face of Power Pole  
S45°W, 72.54' -T.C. Re-mon. tag in Northwest face of Power Pole  
N28°W, 110.18' -T.C. Re-mon. tag in NorthEast face of Power Pole

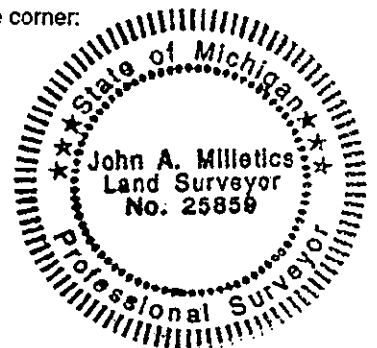

Signed by John A. Milletics  
Surveyor's Michigan License No. 25859

Date May 10, 1998