

SEP 01 1998

SECTION REMONUMENTATION

USER

2 PAGE 200

RECEIVED FOR RECORD

LAND CORNER RECORDATION CERTIFICATE Filing Requirement of Act 74, Mich. P.A. 1970

98 JUN 30 AM 10: 21

LIBER NO. 2 PAGE NO. 200

For corners in

Sanilac

(County)

Located In:

Corner Code #

1. Public Land Survey	T 13NR 12E	A-11
	T R	
	T R	
	T R	
2. Property Controlling in Section	S T R	
	S T R	
3. Miscellaneous Property in Sec.	S T R	
	S T R	

MICHELE VAN NORMAN REGISTER OF DEEDS SANILAC CO., MICHIGAN

Register of Deeds Stamp & File Number

4. Lot No. , Recorded Plat  
5. Private Claims

I, John A. Milletics, in a field survey on May 1, 1998 do hereby state that under requirements of P.A. 74, Michigan P.A. of 1970, the corner points mentioned in lines 1 and 2 above were in conformance with regulations and rules therefore as required in the current manual of survey instructions of the United States Department of the Interior, Bureau of Land Management or by a decree of a Court of Law and /or that the corner points mentioned in lines 3, 4 and 5 above were in conformance with the rules of the Michigan Board of Land Surveyors or by a Decree of a Court of Law; established, re-established, monumented, recovered, found as expressed below:

NOTE: Not more than 2 corners, all in the same town and range, may be recorded on this certificate.

	A	B	C	D	E	F	G	H	I	J	K	L
1												
2	6		5		4		3		2		1	
3												
4	7		8		9		10		11		12	
5												
6	18		17		16		15		14		13	
7												
8	19		20		21		22		23		24	
9												
10	30		29		28		27		26		25	
11												
12	31		32		33		34		35		36	
13												

A. Description of original monument and accessories and/or subsequent restoration:

1834 GLO Notes-Harvey Parke, D.S.-Set post corner Secs. 25 & 36-Cedar 7 N17W 18; B. Ash 9 S8 1/2 W 3 1/2  
Old Survey Liber F.F. Rogers  
Act 132 Liber 3 Page 116 & 117

B. Description of corner evidence found and/or method applied in restoring or reestablishing corner:

A-11

Found Concrete Monument with Brass Cap  
North 2649.31 to the W 1/4 Corner Section 30  
South 2638.80 to the W 1/4 Corner Section 31

APPROVED PEER BOARD MEETING  
June 6, 1998

C. Description of monument for corner and accessories established to perpetuate locating the position of the corner:

A-11

Concrete monument with 2" Brass Cap stamped M11 T13N-R11E  
S35°E, 28.56'-Set 1/2" Diameter Reinforcing Rod  
S24°W, 77.00' -T.C. Re-mon. tag above found nail in East face of Telephone Pole  
S53°W, 42.08'-Center of exposed 3/4" iron in top of Triangular Concrete marker  
N42°W, 44.73'-T.C. Re-mon. tag above found in nail in Northeast face of Telephone Pole

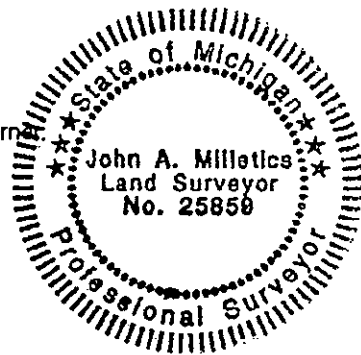

Signed by John A. Milletics  
Surveyor's Michigan License No. 25895

Date May 10, 1998