

Remonumentation

LAND CORNER RECORDATION CERTIFICATE

Filing Requirement of Act 74, Mich. P.A. 1970

RECEIVED FOR RECORD

For corners in

Sanilac (County)	Located In:	Corner Code #
1. Public Land Survey	T <u>13N</u> R <u>12E</u>	C-2 <u>C-3</u>
	T _____ R _____	_____
	T _____ R _____	_____
	T _____ R _____	_____
2. Property Controlling in Section	S _____ T _____ R _____	_____
	S _____ T _____ R _____	_____
3. Miscellaneous Property in Sec.	S _____ T _____ R _____	_____
	S _____ T _____ R _____	_____

95 JUL 10 AM 9:27
LIBER NO. 2 PAGE NO. 58
ESTHER LEE
REGISTER OF DEEDS
SANILAC CO., MICHIGAN

Register of Deeds Stamp & File Number

4. Lot No. _____, Recorded Plat _____
5. Private Claims _____

	A	B	C	D	E	F	G	H	I	J	K	L	M
2	6	5	4	3	2	1							
3													
4	7	8	9	10	11	12							
5													
6	18	17	16	15	14	13							
7													
8	19	20	21	22	23	24							
9													
10	30	29	28	27	26	25							
11													
12	31	32	33	34	35	36							
13													

John A Milletics, in a field survey on May 5, 19 95,

do hereby certify that under requirements of P.A. 74, Michigan P.A. of 1970, the corner points mentioned in lines 1 and 2 above were in conformance with regulations and rules therefore as required in the current manual of survey instructions of the United States Department of the Interior, Bureau of Land Management or by a decree of a Court of Law and/or that the corner points mentioned in lines 3, 4 and 5 above were in conformance with the rules of the Michigan Board of Land Surveyors or by a Decree of a Court of Law; established, re-established, monumented, re-monumented, recovered, found as expressed below:

NOTE: Not more than 4 corners, all in the same town and range, may be recorded on this certificate.

1. Description of original monument and accessories and/or subsequent restoration:

C-2 GLO Notes

Set Post Corner set a 40chain no witnesses list in notes Old Survey Liber Page 316 no date shown, State Highway book Page 11, Act 74 Form None, Act 132 form Liber 4 Page 177, Liber 4 Page 630

C-3 GLO Notes

Set Post at 80 Chains Beech 12 S53°E 12, Beech 10 S25°W 31 Old Survey Liber Page 316 no date shown, Act 74 Form None, Act 132 Form Liber 4 Page 630 State Highway Book Page 11

Approved Peer Group Meeting May 25, 1995

2. Description of corner evidence found and/or method applied in restoring or reestablishing corner:

C-2

W 1/4 Cor Section 5 T13N-R12E Found P.K. Nail as recorded

C-3

SW Cor Section 5 T13N-R12E Found Monu Box

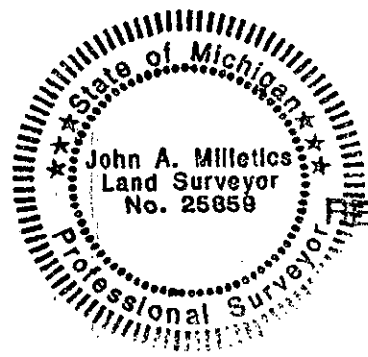

SURVEY & REMONUMENTATION

JUL 31 1995

COMMISSION

3. Description of monument for corner and accessories established to perpetuate locating the position of the corner:

C-2

W 1/4 Cor Section 5 T13N-R12E Monu Box West 39.68 to a nail in a 18" Elm N45W 43.88 to a nail in a 8" Cherry S50W 37.53 to a nail in a 10" Willow East 11.50 to the centerline of the pavement

C-3

NE Cor Section 7 T13N-R12E Monu Box N45°E 60.00 to the SW Cor of Bell Box S45°E 90.63 to a nail in a Power Pole N55°E 55.55 to a stop sign N50°W 77.30 to the SE Cor of a Bell Box S60°W 46.43 to a Stop Sign

Signed by John A. Milletics

Date May 22, 1995

Surveyor's Michigan License No. 25859