

Remonumentation

**LAND CORNER RECORDATION CERTIFICATE**  
**Filing Requirement of Act 74, Mich. P.A. 1970**

For corners in

Sanilac  
 (County)

Located In:

Corner Code #

- |                                    |                           |                |
|------------------------------------|---------------------------|----------------|
| 1. Public Land Survey              | T <u>13N</u> R <u>12E</u> | C-4 <u>C-5</u> |
|                                    | T _____ R _____           | _____          |
|                                    | T _____ R _____           | _____          |
|                                    | T _____ R _____           | _____          |
| 2. Property Controlling in Section | S _____ T _____ R _____   | _____          |
|                                    | S _____ T _____ R _____   | _____          |
| 3. Miscellaneous Property in Sec.  | S _____ T _____ R _____   | _____          |
|                                    | S _____ T _____ R _____   | _____          |

RECEIVED FOR RECORD

95 JUL 10 AM 9:27

LIBER NO. 2 PAGE NO. 59  
 ESTHER LEE  
 REGISTER OF DEEDS  
 SANILAC CO., MICHIGAN

Register of Deeds Stamp & File Number

4. Lot No. \_\_\_\_\_, Recorded Plat \_\_\_\_\_  
 5. Private Claims \_\_\_\_\_

A	B	C	D	E	F	G	H	I	J	K	L	M
2	6	5	4	3	2	1						
3												
4	7	8	9	10	11	12						
5												
6	18	17	16	15	14	13						
7												
8	19	20	21	22	23	24						
9												
10	30	29	28	27	26	25						
11												
12	31	32	33	34	35	36						
13												

I, John A Milletics, in a field survey on May 6, 1995 do hereby certify that under requirements of P.A. 74, Michigan P.A. of 1970, the corner points mentioned in lines 1 and 2 above were in conformance with regulations and rules therefore as required in the current manual of survey instructions of the United States Department of the Interior, Bureau of Land Management or by a decree of a Court of Law and/or that the corner points mentioned in lines 3, 4 and 5 above were in conformance with the rules of the Michigan Board of Land Surveyors or by a Decree of a Court of Law; established, re-established, monumented, re-monumented, recovered, found as expressed below:

**NOTE: Not more than 4 corners, all in the same town and range, may be recorded on this certificate.**

A. Description of original monument and accessories and/or subsequent restoration:

- C-4 GLO Notes  
 Set Post at 40 Chains Elm 14 N84E 13, Hem 7 S51°W 14  
 Old Survey Liber None, State Highway Book Page 10, Act 74 Form None, Act 132 Form None  
 Unrecorded surveys Dated Aug 1985, Sept 1993.
- C-5 GLO Notes Set Post at 80 Chains Birch 12 N46½E 30, Hemloch 10 S70°W 28  
 Old Survey Liber None, State Highway Book Page 10, Act 74 Form Liber 1 Page 296  
 Act 132 Form None, Unrecorded surveys dated Aug 1985, Sept 1993

Approved Peer Group Meeting May 25, 1995

B. Description of corner evidence found and/or method applied in restoring or reestablishing corner:

- C-4  
 E 1/4 Cor Section 7 T13N-R12E  
 Found P.K nail
- C-5  
 NE Cor Section 18 T13N-R12E  
 Found 5/8" iron Bar

**SURVEY & REMONUMENTATION**  
**JUL 3 1 1995**  
**COMMISSION**

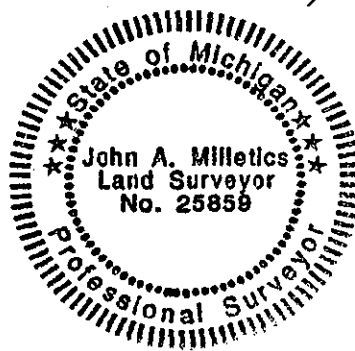

C. Description of monument for corner and accessories established to perpetuate locating the position of the corner:

- |   |   |
|---|---|
| C-4   | C-5   |
| E 1/4 Cor Section 7 T13N-R12E               | NE Cor Section 18 T13N-R12E                 |
| Monu Box                                    | Monu Box                                    |
| West 53.24 to a nail in a Fence Post        | S60°W 11.72 to the South leg of a Road Sign |
| S50W 82.58 to a nail in a 24" Cottonwood    | S70°W 10.20 to the North leg of a Road Sign |
| N40W 75.60 to a nail in a 8" Ash            | N45°W 35.05 to the SE Cor of Bell Box       |
| East 2.2 feet to the centerline of pavement | N10°W 38.35 to the SE Cor of Mail Box       |
|   | N45°E 103.0 to a nail in a Power Pole       |

Signed by John A. Milletics

Date May 22, 1995

Surveyor's Michigan License No. 25859