

SURVEY & REMONUMENTATION

APR 14 1998

LIBER 2 PAGE 154

SECTION

1997 REMONUMENTATION LAND CORNER RECORDATION CERTIFICATE Filing Requirement of Act 74, Mich. P.A. 1970

RECEIVED FOR RECORD 97 DEC -2 AM 9:08 LIBER NO. 2 PAGE NO. 154 ESTHER LEE REGISTER OF DEEDS SANILAC CO., MICHIGAN

For corners in EVERGREEN TOWNSHIP

SANILAC (County)

Located In:

Corner Code #

1. Public Land Survey	T 13N R 12E	M5
	T R	
	T R	
	T R	
2. Property Controlling in Section	S T R	
	S T R	
3. Miscellaneous Property in Sec.	S T R	
	S T R	

SURVEY & REMONUMENTATION

JAN 08 1998

SECTION Register of Deeds Stamp & File Number

4. Lot No. , Recorded Plat
5. Private Claims

I, John A. Milletics, in a field survey on Oct 26, 19 97 do hereby state that under requirements of P.A. 74, Michigan P.A. of 1970, the corner points mentioned in lines 1 and 2 above were in conformance with regulations and rules therefore as required in the current manual of survey instructions of the United States Department of the Interior, Bureau of Land Management or by a decree of a Court of Law and/or that the corner points mentioned in lines 3, 4 and 5 above were in conformance with the rules of the Michigan Board of Land Surveyors or by a Decree of a Court of Law; established, re-established, monumented, recovered, found as expressed below.

NOTE: Not more than 2 corners, all in the same town and range, may be recorded on this certificate.

1	A	B	C	D	E	F	G	H	I	J	K	L	M
2	6	5	4	3	2	1							
3													
4	7	8	9	10	11	12							
5													
6	18	17	16	15	14	13							
7													
8	19	20	21	22	23	24							
9													
10	30	29	28	27	26	25							
11													
12	31	32	33	34	35	36							
13													

A. Description of original monument and accessories and/or subsequent restoration:

- M5
- G.L.O. Notes Set Post Corner Sections 12 and 13
- Beech 14 S38W 40, Beech 11 N66W 13 1/2
- Act 74 Form - None
- Act 132 Form - Liber 2, Page 266
- Road Commission Record - None
- Drain Commission Record - None

B. Description of corner evidence found and/or method applied in restoring or reestablishing corner:

- M5
- Found 3/4" Re-Rod in Monument Box

C. Description of monument for corner and accessories established to perpetuate locating the position of the corner:

- M5. Corner Section 7 and 18, T13N-R13E, and Corner Sections 12 and 13, T13N-R12E
- Found 3/4" Re-Rod in Monument Box
- WITNESSES:
- N40°E 53.52' to 1/2" Steel Stake
- S45°W 37.78' to 1/2" Steel Stake
- S50°E 94.38' to P.K. Nail in S.W. Side P.P.
- N40°W 45.90' to Notch W. End 12" CMP
- East 2616.57' to B5, T13N-R13E
- West 2705.20' to L5, T13N-R12E

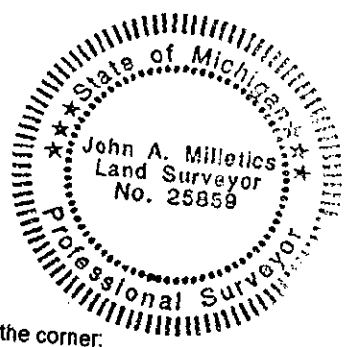

Signed by [Signature]

Surveyor's Michigan License No. 25859

Date Nov 12, 1997

PEER GROUP APPROVED AT MEETING HELD

NOV. 26 1997