

98 DEC -1 AM 9:08

REMONUMENTATION

LAND CORNER RECORDATION CERTIFICATE

Filing Requirement of Act 74, Mich. P.A. 1970 LIBER NO. 2 PAGE NO. 238

For corners in

Sanilac

(County)

Located In:

Corner Code #

1. Public Land Survey

T13N R13E

A-6

T R

T R

T R

2. Property Controlling in Section

S T R

S T R

3. Miscellaneous Property in Sec.

S T R

S T R

MICHELE VANNORMAN REGISTER OF DEEDS SANILAC CO., MICHIGAN

Register of Deeds Stamp & File Number

4. Lot No. , Recorded Plat

5. Private Claims

I, John A. Millettics, in a field survey on Oct 5, 1998 do hereby state that under requirements of P.A. 74, Michigan P.A. of 1970, the corner points mentioned in lines 1 and 2 above were in conformance with regulations and rules therefore as required in the current manual of survey instructions of the United States Department of the Interior, Bureau of Land Management or by a decree of a Court of Law and /or that the corner points mentioned in lines 3, 4 and 5 above were in conformance with the rules of the Michigan Board of Land Surveyors or by a Decree of a Court of Law; established, re-established, monumented, recovered, found as expressed below.

NOTE: Not more than 2 corners, all in the same town and range, may be recorded on this certificate.

Grid table with columns A-M and rows 1-13. Cell 6,18 contains a dot.

A. Description of original monument and accessories and/or subsequent restoration:

A-6 GLO Notes - Birch 10 S14W 40; Birch 13 N26W 33

Old Survey Liber-Survey by Thomas Nicol 1905 Road Comm - None Act 132 - None L.C.R.C. - None

SURVEY & REMONUMENTATION

JAN 15 1999

SECTION

B. Description of corner evidence found and/or method applied in restoring or reestablishing corner:

A-6 W 1/4 Corner Section 18 T13N-R13E Found 2" Iron Bar in Gravel Road Bed Accepted as best evidence North 2658.68 feet to the NW Corner Section 18 South 2653.00 feet to the SW Corner Section 18

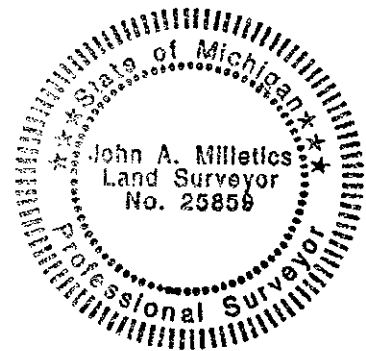

APPROVED PEER BOARD MEETING NOV 30, 1998 gm

C. Description of monument for corner and accessories established to perpetuate locating the position of the corner:

A-6

2" Iron Bar West, 16.0' Nail in Fence Post North 2658.68 feet to the NW Corner Section 18 N80°E, 16.20' Nail in 12" Cherry South 2653.00 feet to the SW Corner Section 18 S75°E, 31.40' Nail in 24" Maple S45°E, 22.50' Nail in 12" Cherry

Signed by [Signature] Surveyor's Michigan License No. 25859

Date Nov 18, 1998