

REMONUMENTATION

LAND CORNER RECORDATION CERTIFICATE
Filing Requirement of Act 74, Mich. P.A. 1970

98 DEC -1 AM 9:08

LIBER NO. 2 PAGE NO. 241

For corners in

Sanilac

(County)

Located In:

Corner Code #

- 1. Public Land Survey T13N R13E A-9
T R
T R
T R
- 2. Property Controlling in Section S T R
S T R
- 3. Miscellaneous Property in Sec. S T R
S T R

MICHELE VAN NORMAN
REGISTER OF DEEDS
SANILAC CO., MICHIGAN

Register of Deeds Stamp & File Number

- 4. Lot No. _____, Recorded Plat _____
- 5. Private Claims _____

I, John A. Milletics, in a field survey on Oct 5, 19 98 do hereby state that under requirements of P.A. 74, Michigan P.A. of 1970, the corner points mentioned in lines 1 and 2 above were in conformance with regulations and rules therefore as required in the current manual of survey instructions of the United States Department of the Interior, Bureau of Land Management or by a decree of a Court of Law and/or that the corner points mentioned in lines 3, 4 and 5 above were in conformance with the rules of the Michigan Board of Land Surveyors or by a Decree of a Court of Law; established, re-established, monumented, recovered, found as expressed below:

NOTE: Not more than 2 corners, all in the same town and range, may be recorded on this certificate.

	A	B	C	D	E	F	G	H	I	J	K	L	M
1													
2	6		5		4		3		2		1		
3													
4	7		8		9		10		11		12		
5													
6	18		17		16		15		14		13		
7													
8	19		20		21		22		23		24		
9													
10	30		29		28		27		26		25		
11													
12	31		32		33		34		35		36		
13													

A. Description of original monument and accessories and/or subsequent restoration:

- A-9 GLO Notes - B. Ash 9 S31W 6; Elm 13 N21W 30
Old Survey Liber-Survey by Thomas Nicol 1905
Survey by Thomas Nicol 1906
Act 132 Liber 3, Page 156
Unrecorded Survey dated 5-13-94
L.C.R.C. - None

SURVEY & REMONUMENTATION

JAN 15 1999

SECTION

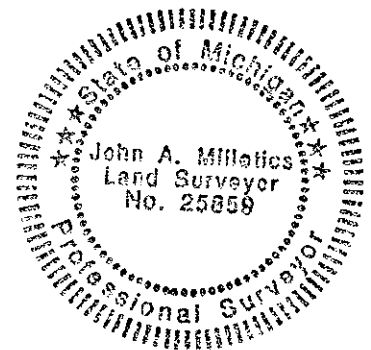

B. Description of corner evidence found and/or method applied in restoring or reestablishing corner:

- A-9 SW Corner Section 19 T13N-R13E
Found 1/2" Iron bar in Gravel Road Bed
Accepted as best evidence
North 2667.32 feet to the W 1/4 Corner Section 19
South 2664.90 feet to the W 1/4 Corner Section 30

APPROVED PEER BOARD MEETING
NOV 30, 1998

C. Description of monument for corner and accessories established to perpetuate locating the position of the corner:

- A-9
1/2" Iron Bar with cap North 2667.32 feet to the W 1/4 Corner Section 19
S30°W, 82.60' Nail in 36" Maple South 2664.90 feet to the W 1/4 Corner Section 30
S40°E, 33.90' To Stop Sign
S55°E, 33.70' To Bell Box
N40°W, 37.35' To Stop Sign

Signed by John A. Milletics
Surveyor's Michigan License No. 25859

Date Nov 18, 1998