

98 DEC -1 AM 9:08

REMONUMENTATION

LAND CORNER RECORDATION CERTIFICATE
Filing Requirement of Act 74, Mich. P.A. 1970

LIBER NO. 2 PAGE NO. 243

For corners in

MICHELE VANNORMAN
REGISTER OF DEEDS
SANILAC CO., MICHIGAN

Sanilac (County)	Located In:	Corner Code #
1. Public Land Survey	T13N R13E	A-11
	T R	
	T R	
	T R	
2. Property Controlling in Section	S T R	
	S T R	
3. Miscellaneous Property in Sec.	S T R	
	S T R	

Register of Deeds Stamp & File Number

4. Lot No. _____, Recorded Plat _____
5. Private Claims _____

I, John A. Milletics, in a field survey on Oct 5, 1998 do hereby state that under requirements of P.A. 74, Michigan P.A. of 1970, the corner points mentioned in lines 1 and 2 above were in conformance with regulations and rules therefore as required in the current manual of survey instructions of the United States Department of the Interior, Bureau of Land Management or by a decree of a Court of Law and/or that the corner points mentioned in lines 3, 4 and 5 above were in conformance with the rules of the Michigan Board of Land Surveyors or by a Decree of a Court of Law; established, re-established, monumented, recovered, found as expressed below:

NOTE: Not more than 2 corners, all in the same town and range, may be recorded on this certificate.

	A	B	C	D	E	F	G	H	I	J	K	L	M
1													
2	6		5		4		3		2		1		
3													
4	7		8		9		10		11		12		
5													
6	18		17		16		15		14		13		
7													
8	19		20		21		22		23		24		
9													
10	30		29		28		27		26		25		
11													
12	31		32		33		34		35		36		
13													

A. Description of original monument and accessories and/or subsequent restoration:

A-11
GLO Notes - Hemlock 18 N39W 46; Birch 7 S43W 14
Old Survey Liber-Survey by Thomas Nicol 1905
Act 132 - Liber 3 Page 156
L.C.R.C. - None
Unrecorded survey dated 11-24-78

SURVEY & REMONUMENTATION

JAN 15 1999

SECTION

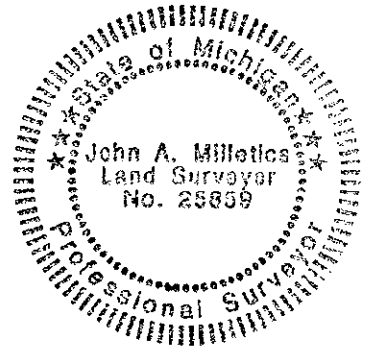

B. Description of corner evidence found and/or method applied in restoring or reestablishing corner:

A-11
SW Corner Section 30 T13N-R13E
Found Monu Box with 5/8' Iron in Box
Accepted as best evidence

North 2655.82 feet to the W 1/4 Corner Section 30
South 2653.96 feet to the W 1/4 Corner Section 31

APPROVED PEER BOARD MEETING
NOV 30, 1998

C. Description of monument for corner and accessories established to perpetuate locating the position of the corner:

A-11
Monument Box with 5/8" iron in Box
S45°W, 55.15' Nail in 36" Ash
S30°W, 89.60' Nail in 6" Pine
S30°E, 38.70' To Stop Sign
N40°W, 64.20' To Power Pole

North 2655.82 feet to the W 1/4 Corner Section 30
South 2653.96 feet to the W 1/4 Corner Section 31

Signed by John A. Milletics
Surveyor's Michigan License No. 25859

Date Nov 18, 1998