

**SURVEY &
REMONUMENTATION**

APR 14 1998

REMONUMENTATION
SECTION

LIBER 2 PAGE 175

LAND CORNER RECORDATION CERTIFICATE
Filing Requirement of Act 74, Mich. P.A. 1970

RECEIVED FOR RECORD

97 DEC -2 AM 9:10

LIBER NO. 2 PAGE NO. 175

ESTHER LEE
REGISTER OF DEEDS
SANILAC CO., MICHIGAN

For corners in WHEATLAND TOWNSHIP

<u>Sanilac</u> (County)	Located In:	Corner Code #
1. Public Land Survey	T <u>13</u> N R <u>14</u> E	<u>E - 11</u>
	T <u> </u> R <u> </u>	<u> </u>
	T <u> </u> R <u> </u>	<u> </u>
	T <u> </u> R <u> </u>	<u> </u>
2. Property Controlling in Section	S <u> </u> T <u> </u> R <u> </u>	<u> </u>
	S <u> </u> T <u> </u> R <u> </u>	<u> </u>
3. Miscellaneous Property in Sec.	S <u> </u> T <u> </u> R <u> </u>	<u> </u>
	S <u> </u> T <u> </u> R <u> </u>	<u> </u>

**SURVEY &
REMONUMENTATION**

JAN 08 1998

Register of Deeds Section File Number

4. Lot No. _____, Recorded Plat _____
5. Private Claims _____

I, John A Milletics, in a field survey on July 28, 1997 do hereby state that under requirements of P.A. 74, Michigan P.A. of 1970, the corner points mentioned in lines 1 and 2 above were in conformance with regulations and rules therefore as required in the current manual of survey instructions of the United States Department of the Interior, Bureau of Land Management or by a decree of a Court of Law and/or that the corner points mentioned in lines 3, 4 and 5 above were in conformance with the rules of the Michigan Board of Land Surveyors or by a Decree of a Court of Law; established, re-established, monumented, recovered, found as expressed below:

1	A	B	C	D	E	F	G	H	I	J	K	L	M
2		6		5		4		3		2		1	
3													
4		7		8		9		10		11		12	
5													
6		10		17		16		15		14		13	
7													
8		19		20		21		22		23		24	
9													
10		30		29		28		27		26		25	
11													
12		31		32		33		34		35		36	
13													

NOTE: Not more than 2 corners, all in the same town and range, may be recorded on this certificate.

A. Description of original monument and accessories and/or subsequent restoration:

E - 11
GLO Notes
Set Post Corner
B. Ash 10 N40 1/2 W 29
B. Ash 8 s34° E 26

Old Survey Liber, survey dated May 1896 by Ward, survey dated Aug 1886 by Rogers
Act 74 None
Act 132 None
Unrecorded survey dated July 13, 1978 showing sectional breck down

B. Description of corner evidence found and/or method applied in restoring or reestablishing corner:

E - 11
Found Monu Box in place with 5/8" Iron Bar

APPROVED PEER BOARD MEETING
NOV. 26, 1997 *JM*

C. Description of monument for corner and accessories established to perpetuate locating the position of the corner:

E - 11
NE Corner Section 32 T13N-R14E Wheatland Twp.
Monu Box in place with 5/8" Iron Bar
N25°W 44.68 feet to the SE Corner of a Riser Box
N05°W 20.75 feet to the West leg of a Road Sign
N05°E 20.75 feet to the East leg of a Road Sign
N20°E 56.12 feet to a nail in a Power Pole
S45°E 49.56 feet to a Stop Sign
South 2645.56 feet to the E 1/4 Corner Section 32

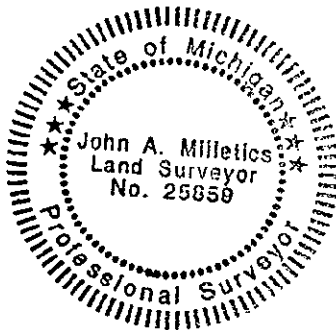

Signed by *John A. Milletics*
Surveyor's Michigan License No. 25859

Date Nov 12, 1997