

**SURVEY & REMONUMENTATION**

APR 14 1998

LIBER 2 PAGE 174

REMONUMENTATION SECTION

LAND CORNER RECORDATION CERTIFICATE  
Filing Requirement of Act 74, Mich. P.A. 1970

RECEIVED FOR RECORD

97 DEC -2 AM 9:10

LIBER NO. 2 PAGE NO. 174  
ESTHER LEE  
REGISTER OF DEEDS  
SANILAC CO., MICHIGAN

For corners in WHEATLAND TOWNSHIP

Sanilac (County)	Located In:	Corner Code #
1. Public Land Survey	T13N R14E	E - 12
	T R	
	T R	
	T R	
2. Property Controlling in Section	S T R	
	S T R	
3. Miscellaneous Property in Sec.	S T R	
	S T R	

**SURVEY & REMONUMENTATION**

JAN 08 1998

Register of Deeds SECTION Number

4. Lot No. \_\_\_\_\_, Recorded Plat \_\_\_\_\_  
5. Private Claims \_\_\_\_\_

I, John A Milletics, in a field survey on July 28, 1997 do hereby state that under requirements of P.A. 74, Michigan P.A. of 1970, the corner points mentioned in lines 1 and 2 above were in conformance with regulations and rules therefore as required in the current manual of survey instructions of the United States Department of the Interior, Bureau of Land Management or by a decree of a Court of Law and/or that the corner points mentioned in lines 3, 4 and 5 above were in conformance with the rules of the Michigan Board of Land Surveyors or by a Decree of a Court of Law; established, re-established, monumented, recovered, found as expressed below:

NOTE: Not more than 2 corners, all in the same town and range, may be recorded on this certificate.

	A	B	C	D	E	F	G	H	I	J	K	L	M
1													
2	6			5		4		3		2		1	
3													
4	7			8		9		10		11		12	
5													
6	18			17		16		15		14		13	
7													
8	19			20		21		22		23		24	
9													
10	30			29		28		27		26		25	
11													
12	31			32		33		34		35		36	
13													

A. Description of original monument and accessories and/or subsequent restoration:

E - 12

GLO NOTES

Set 1/4 Section Post  
Hemlock 14 N69°W 34  
Sugar 6 S58½°E 13

Old Survey Liber, survey dated May 1896 by  
Ward, survey dated Aug 1886 Rogers  
Act 74 None  
Act 132 None  
Unrecorded survey dated July 13, 1978

B. Description of corner evidence found and/or method applied in restoring or reestablishing corner:

E - 12

Found Monu Box in place with 5/8" Iron Bar

APPROVED PEER BOARD MEETING  
NOV. 26, 1997 *JM*

C. Description of monument for corner and accessories established to perpetuate locating the position of the corner:

E - 12

E 1/4 Cor Section 32 T13n-R14E Wheatland Twp.  
Monu Box in place with 5/8" Iron Bar  
East 50.00 feet to a 1/2" Iron Bar  
S85°E 39.49 feet to the SW corner of a Riser Box  
N30°W 41.78 feet to the SE corner of a Mailbox post  
S20°W 98.65 feet to the NE corner of a Mailbox post  
South 2641.42 feet to the SE Corner of Section 32  
North 2645.56 feet to the NE Corner of Section 32

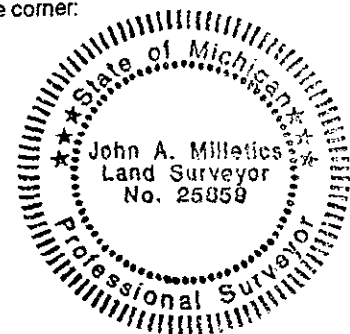

Signed by *John A. Milletics*  
Surveyor's Michigan License No. 25859

Date Nov 12, 1997