

98 DEC -1 AM 9:09

LIBER NO. 2 PAGE NO. 262

REMONUMENTATION

LAND CORNER RECORDATION CERTIFICATE  
Filing Requirement of Act 74, Mich. P.A. 1970

MICHELE VAN NORMAN  
REGISTER OF DEEDS  
SANILAC CO., MICHIGAN

For corners in

Sanilac (County)	Located In:	Corner Code #
1. Public Land Survey	T13N R15E	A-3
	T___ R___	_____
	T___ R___	_____
	T___ R___	_____
2. Property Controlling in Section	S___ T___ R___	_____
	S___ T___ R___	_____
3. Miscellaneous Property in Sec.	S___ T___ R___	_____
	S___ T___ R___	_____

Register of Deeds Stamp & File Number

4. Lot No. \_\_\_\_\_, Recorded Plat \_\_\_\_\_  
5. Private Claims \_\_\_\_\_

I, John A. Milletics, in a field survey on Oct 12, 1998 do hereby state that under requirements of P.A. 74, Michigan P.A. of 1970, the corner points mentioned in lines 1 and 2 above were in conformance with regulations and rules therefore as required in the current manual of survey instructions of the United States Department of the Interior, Bureau of Land Management or by a decree of a Court of Law and/or that the corner points mentioned in lines 3, 4 and 5 above were in conformance with the rules of the Michigan Board of Land Surveyors or by a Decree of a Court of Law; established, re-established, monumented, recovered, found as expressed below:

NOTE: Not more than 2 corners, all in the same town and range, may be recorded on this certificate.

A. Description of original monument and accessories and/or subsequent restoration:

A-3 GLO Notes - Hemlock 14 S40W 39; Hemlock 10 N14W 35  
Old Survey Liber-None  
L.C.R.C. - None  
Act 132 - Liber 4 Page 260  
Unrecorded survey dated 5-30-91 showing W 1/4 Cor  
Road Comm. - None

B. Description of corner evidence found and/or method applied in restoring or reestablishing corner:

A-3  
SW Corner Section 6 T13N-R15E  
Found 5/8" Iron Bar in gravel Road Bed  
Accepted as best evidence

C. Description of monument for corner and accessories established to perpetuate locating the position of the corner:

A-3  
SW Corner Section 6 T13N-R15E  
5/8" Iron Bar  
N55°W 48.62 to a nail in a Power Pole  
N25°W 36.10 to a Stop Sign  
S25°E 38.15 to a Stop Sign  
N50°E 62.80 to a Bell Box  
North 2640.36 to the W 1/4 Cor Section 6  
South 2651.80 to the W 1/4 Cor Section 7

	A	B	C	D	E	F	G	H	I	J	K	L	M
1													
2	6			5			4			3			2
3													
4	7			8			9			10			11
5													
6	18			17			16			15			14
7													
8	19			20			21			22			23
9													
10	30			29			28			27			26
11													
12	31			32			33			34			35
13													

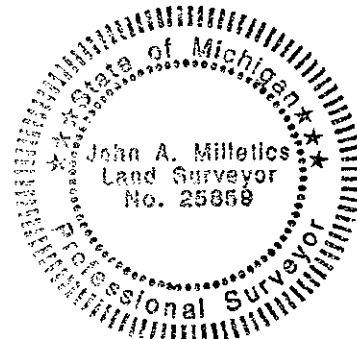

APPROVED PEER BOARD MEETING  
NOV 30, 1998

*gm*

SURVEY &  
REMONUMENTATION

JAN 15 1999

SECTION

Signed by *John A. Milletics*  
Surveyor's Michigan License No. 25859

Date Nov 19, 1998