

RECEIVED FOR RECORD

98 DEC -1 AM 9:10

LIBER NO. 2 PAGE NO. 265

MICHELE VAN NORMAN  
REGISTER OF DEEDS  
SANILAC CO., MICHIGAN

REMONUMENTATION

LAND CORNER RECORDATION CERTIFICATE  
Filing Requirement of Act 74, Mich. P.A. 1970

For corners in

Sanilac (County)	Located In:	Corner Code #
1. Public Land Survey	T13N R15E	A-6
	T___ R___	_____
	T___ R___	_____
	T___ R___	_____
2. Property Controlling in Section	S___ T___ R___	_____
	S___ T___ R___	_____
3. Miscellaneous Property in Sec.	S___ T___ R___	_____
	S___ T___ R___	_____

Register of Deeds Stamp & File Number

4. Lot No. \_\_\_\_\_, Recorded Plat \_\_\_\_\_  
5. Private Claims \_\_\_\_\_

I, John A. Milletics, in a field survey on Oct 12, 1998 do hereby state that under requirements of P.A. 74, Michigan P.A. of 1970, the corner points mentioned in lines 1 and 2 above were in conformance with regulations and rules therefore as required in the current manual of survey instructions of the United States Department of the Interior, Bureau of Land Management or by a decree of a Court of Law and /or that the corner points mentioned in lines 3, 4 and 5 above were in conformance with the rules of the Michigan Board of Land Surveyors or by a Decree of a Court of Law; established, re-established, monumented, recovered, found as expressed below:

NOTE: Not more than 2 corners, all in the same town and range, may be recorded on this certificate.

	A	B	C	D	E	F	G	H	I	J	K	L	M
1													
2		6		5		4		3		2		1	
3													
4		7		8		9		10		11		12	
5													
6		18		17		16		15		14		13	
7													
8		19		20		21		22		23		24	
9													
10		30		29		28		27		26		25	
11													
12		31		32		33		34		35		36	
13													

A. Description of original monument and accessories and/or subsequent restoration:

A-6 GLO Notes - Aspen 4 S42W 59; Aspen 6 N56W 75 1/2  
Old Survey Liber - None  
L.C.R.C. - None  
Act 132 - None  
Unrecorded survey dated 8-19-80  
Road Comm - None

B. Description of corner evidence found and/or method applied in restoring or reestablishing corner:

A-6 W 1/4 Corner Section 18 T13N-R15E  
Found 5/8" Iron Bar raised with 1/2" Iron Bar and cap  
Accepted as best evidence  
North 2639.81 feet to the NW Corner Section 18  
South 2646.04 feet to the SW Corner Section 18

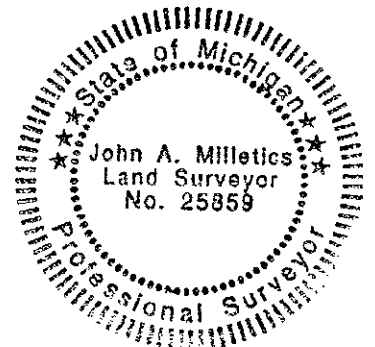

APPROVED PEER BOARD MEETING  
NOV 30, 1998

*gm*

C. Description of monument for corner and accessories established to perpetuate locating the position of the corner:

A- 6  
W 1/4 Corner Section 18 T13N-R15E  
1/2" Iron Bar  
West 44.55 feet to a nail in a Wooden Fence Post  
S20°W 144.65 feet to a nail in a Power Pole  
N20°W 159.50 feet to a nail in a Power Pole  
S80°W 33.00 feet to a 1/2" Iron Bar  
North 2639.81 feet to the NW Corner Section 18  
South 2646.04 feet to the SW Corner Section 18

SURVEY &  
REMONUMENTATION

JAN 15 1999

SECTION

Signed by *John A. Milletics*  
Surveyor's Michigan License No. 25859

Date Nov 19, 98