

98 DEC -1 AM 9:10

REMONUMENTATION

LAND CORNER RECORDATION CERTIFICATE
Filing Requirement of Act 74, Mich. P.A. 1970

LIBER NO. 2 PAGE NO. 256

For corners in

Sanilac (County)	Located In:	Corner Code #
1. Public Land Survey	T13N R15E	A-7
	T___ R___	_____
	T___ R___	_____
	T___ R___	_____
2. Property Controlling in Section	S___ T___ R___	_____
	S___ T___ R___	_____
3. Miscellaneous Property in Sec.	S___ T___ R___	_____
	S___ T___ R___	_____

MICHELE VANNORMAN
REGISTER OF DEEDS
SANILAC CO., MICHIGAN

Register of Deeds Stamp & File Number

4. Lot No. _____, Recorded Plat _____
5. Private Claims _____

I, John A. Milletics, in a field survey on Oct 12, 19 98 do hereby state that under requirements of P.A. 74, Michigan P.A. of 1970, the corner points mentioned in lines 1 and 2 above were in conformance with regulations and rules therefore as required in the current manual of survey instructions of the United States Department of the Interior, Bureau of Land Management or by a decree of a Court of Law and/or that the corner points mentioned in lines 3, 4 and 5 above were in conformance with the rules of the Michigan Board of Land Surveyors or by a Decree of a Court of Law; established, re-established, monumented, recovered, found as expressed below:

NOTE: Not more than 2 corners, all in the same town and range, may be recorded on this certificate.

	A	B	C	D	E	F	G	H	I	J	K	L	M
1													
2	6		5		4		3		2		1		
3													
4	7		8		9		10		11		12		
5													
6	18		17		16		15		14		13		
7													
8	19		20		21		22		23		24		
9													
10	30		29		28		27		26		25		
11													
12	31		32		33		34		35		36		
13													

A. Description of original monument and accessories and/or subsequent restoration:

A-7 GLO Notes - Cedar 16 S4W 45; Cedar 16 N77W 41
Old Survey Liber - None
Act 132 - None
L.C.R.C. - None
Unrecorded Survey - dated 8-19-80

B. Description of corner evidence found and/or method applied in restoring or reestablishing corner:

A-7
SW Corner Section 18 T13N-R15E
Found 5/8" Iron Bar
Accepted as best evidence
North 2646.04 feet to the W 1/4 Corner Section 18
South 2654.36 feet to the W 1/4 Corner Section 19

APPROVED PEER BOARD MEETING
NOV 30, 1998

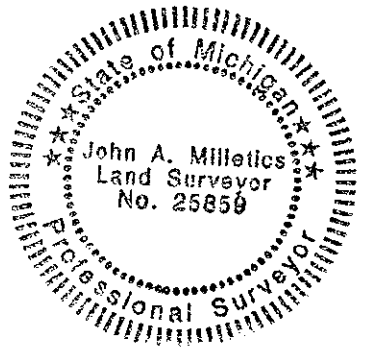

C. Description of monument for corner and accessories established to perpetuate locating the position of the corner:

A-7
SW Corner Section 18 T13N-R15E
5/8" Iron Bar
N45°W 50.15 feet to a nail in a Telephone
N45°E 66.30 feet to a nail in a Telephone
S45°E 63.15 feet to a nail in a Power Pole
S40°W 63.50 feet to a nail in a Power Pole
North 2646.04 feet to the W 1/4 Corner Section 18
South 2654.36 feet to the W 1/4 Corner Section 19

SURVEY &
REMONUMENTATION

JAN 15 1999

SECTION

Signed by [Signature]

Date Nov 19, 98

Surveyor's Michigan License No. 25859