

LIBER 2 PAGE 39
MAY 17 1997

REMONUMENTATION

LAND CORNER RECORDATION CERTIFICATE
Filing Requirement of Act 74, Mich. P.A. 1970

RECEIVED FOR RECORD

96 DEC 10 AM 11:56

LIBER NO. 2 PAGE NO. 99
ESTHER LEE
REGISTER OF DEEDS
SANILAC CO. MICHIGAN

For corners in

Sanilac (County)	Located In:	Corner Code #
1. Public Land Survey	T13N R 15E	J-13 K-13
	T R	
	T R	
	T R	
2. Property Controlling in Section	S T R	
	S T R	
3. Miscellaneous Property in Sec.	S T R	
	S T R	

Register of Deeds Stamp & File Number

4. Lot No. _____, Recorded Plat _____
5. Private Claims _____

I, John A Milletics, in a field survey on June 22, 1996 do hereby state that under requirements of P.A. 74, Michigan P.A. of 1970, the corner points mentioned in lines 1 and 2 above were in conformance with regulations and rules therefore as required in the current manual of survey instructions of the United States Department of the Interior, Bureau of Land Management or by a decree of a Court of Law and/or that the corner points mentioned in lines 3, 4 and 5 above were in conformance with the rules of the Michigan Board of Land Surveyors or by a Decree of a Court of Law; established, re-established, monumented, recovered, found as expressed below:

NOTE: Not more than 2 corners, all in the same town and range, may be recorded on this certificate.

	A	B	C	D	E	F	G	H	I	J	K	L	M
1													
2	6		5		4		3		2		1		
3													
4	7		8		9		10		11		12		
5													
6	18		17		16		15		14		13		
7													
8	19		20		21		22		23		24		
9													
10	30		29		28		27		26		25		
11													
12	31		32		33		34		35		36		
13													

A. Description of original monument and accessories and/or subsequent restoration:

J-13 GLO Notes No Old Survey Liber
 40.00 Set 1/4 Section Post No Act 74 - No Act 132
 Beech 14 N38E 45 1/2 No Road Comm or Drain Comm notes
 Beech 14 N16W 28 Two unrecorded surveys dated 12-89, 11-92

K-13 GLO Notes No Old Survey Liber
 80.00 Set Corner Post No Act 74 - No Act 132
 Beech 15 N60E 21 No Road Comm or Drain Comm Notes
 Sugar 17 N81 1/2 W 51 Two unrecorded surveys dated 12-89, 11-92

B. Description of corner evidence found and/or method applied in restoring or reestablishing corner:

J-13
 S 1/4 Cor Section 35 T13N-R15E
 Reset 1/2" iron Bar as per surveys dated 12-89, 11,92

K-13
 SE Corner Section 35 T13N-R15E
 Found 5/8" iron bar in gravel Road Bed

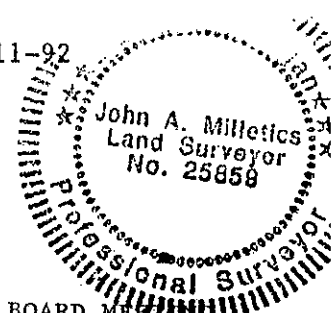

APPROVED PEER BOARD MEMBER

12-02-96 JM

C. Description of monument for corner and accessories established to perpetuate locating the position of the corner:

J-13	S 1/4 Cor Section 35 T13N-R15E	K-13	SE Corner Section 35 T13N-R15E
	1/2" iron bar in gravel road bed		5/8" Iron Bar in gravel Road Bed
	North 32.60 feet to a Bell Box		West 1.98 feet to a 1/2" Iron Bar
	S20°W 35.92 feet to a Bell Box		N45°E 47.10 feet to a Bell Box
	S15°E 60.82 feet to a nail in a Power Pole		N40°E 70.30 feet to a nail in a 6" Pine
	West 2644.36 feet to SW Cor of Section		N45°W 45.90 feet to a Stop Sign
	East 2644.36 feet to SE Cor of Section		S45°E 53.85 feet to a Stop Sign
			West 2644.36 feet to S 1/4 Cor
			East 2645.28 feet to S 1/4 Cor

Signed by [Signature]
Surveyor's Michigan License No. 25859

Date Sept 28, 1996