

SURVEY & REMONUMENTATION

LIBER 2 PAGE 99
MAY 07 1997

COMMISSION

REMONUMENTION

LAND CORNER RECORDATION CERTIFICATE
Filing Requirement of Act 74, Mich. P.A. 1970

RECEIVED FOR RECORD

96 DEC 10 AM 11:56

LIBER NO. 2 PAGE NO. 99
ESTHER LEE
REGISTER OF DEEDS
SARILAC CO. MICHIGAN

For corners in

Sanilac

(County)

Located in:

Corner Code #

1. Public Land Survey

T13N R 15E

J-13 K-13

T R

T R

T R

2. Property Controlling in Section

S T R

3. Miscellaneous Property in Sec.

S T R

S T R

S T R

4. Lot No. , Recorded Plat

5. Private Claims

Register of Deeds Stamp & File Number

I, John A Milletics, in a field survey on June 22, 1996 do hereby state that under requirements of P.A. 74, Michigan P.A. of 1970, the corner points mentioned in lines 1 and 2 above were in conformance with regulations and rules therefore as required in the current manual of survey instructions of the United States Department of the Interior, Bureau of Land Management or by a decree of a Court of Law and for that the corner points mentioned in lines 3, 4 and 5 above were in conformance with the rules of the Michigan Board of Land Surveyors or by a Decree of a Court of Law, established, re-established, monumented, recovered, found as expressed below:

NOTE: Not more than 2 corners, all in the same town and range, may be recorded on this certificate.

A. Description of original monument and accessories and/or subsequent restoration:

J-13 GLO Notes
40.00 Set 1/4 Section Post
Beech 14 N38E 45 1/2
Beech 14 N16W 28

No Old Survey Liber
No Act 74 - No Act 132
No Road Comm or Drain Comm notes
Two unrecorded surveys dated 12-89, 11-92

K-13 GLO Notes
80.00 Set Corner Post
Beech 15 N60E 21
Sugar 17 N81 1/2 W 51

No Old Survey Liber
No Act 74 - No Act 132
No Road Comm or Drain Comm Notes
Two unrecorded surveys dated 12-89, 11-92

B. Description of corner evidence found and/or method applied in restoring or reestablishing corner:

J-13
S 1/4 Cor Section 35 T13N-R15E
Reset 1/2" iron Bar as per surveys dated 12-89, 11, 92

K-13
SE Corner Section 35 T13N-R15E
Found 5/8" iron bar in gravel Road Bed

	A	B	C	D	E	F	G	H	I	J	K	L	M
1													
2	6		5		4		3		2		1		
3													
4	7		8		9		10		11		12		
5													
6	18		17		16		15		14		13		
7													
8	19		20		21		22		23		24		
9													
10	30		29		28		27		26		25		
11													
12	31		32		33		34		35		36		
13													

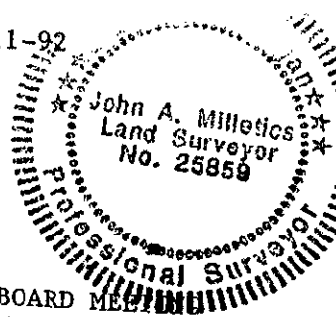

APPROVED PEER BOARD MEMBER
12-02-96 JM

C. Description of monument for corner and accessories established to perpetuate locating the position of the corner:

J-13
S 1/4 Cor Section 35 T13N-R15E
1/2" iron bar in gravel road bed
North 32.60 feet to a Bell Box
S20°W 35.92 feet to a Bell Box
S15°E 60.82 feet to a nail in a Power Pole
West 2644.36 feet to SW Cor of Section
East 2644.36 feet to SE Cor of Section

K-13
SE Corner Section 35 T13N-R15E
5/8" Iron Bar in gravel Road Bed
West 1.98 feet to a 1/2" Iron Bar
N45°E 47.10 feet to a Bell Box
N40°E 70.30 feet to a nail in a 6" Pine
N45°W 45.90 feet to a Stop Sign
S45°E 53.85 feet to a Stop Sign
West 2644.36 feet to S 1/4 Cor
East 2645.28 feet to S 1/4 Cor

Signed by [Signature]
Surveyor's Michigan License No. 25859

Date Sept 28, 1996