

LIBER

2 PAGE 224

RECEIVED FOR RECORD

98 DEC -1 AM 9:07

REMONUMENTATION

LAND CORNER RECORDATION CERTIFICATE
Filing Requirement of Act 74, Mich. P.A. 1970

LIBER NO. 2 PAGE NO. 224

MICHELE VANNORMAN
REGISTER OF DEEDS
SANILAC CO., MICHIGAN

For corners in

Sanilac (County)	Located in:	Corner Code #
1. Public Land Survey	T13N R16E	A-2
	T R	
	T R	
	T R	
2. Property Controlling in Section	S T R	
	S T R	
3. Miscellaneous Property in Sec.	S T R	
	S T R	

Register of Deeds Stamp & File Number

4. Lot No. _____, Recorded Plat _____
5. Private Claims _____

I, John A. Milletics, in a field survey on Oct 25, 1998 do hereby state that under requirements of P.A. 74, Michigan P.A. of 1970, the corner points mentioned in lines 1 and 2 above were in conformance with regulations and rules therefore as required in the current manual of survey instructions of the United States Department of the Interior, Bureau of Land Management or by a decree of a Court of Law and/or that the corner points mentioned in lines 3, 4 and 5 above were in conformance with the rules of the Michigan Board of Land Surveyors or by a Decree of a Court of Law; established, re-established, monumented, recovered, found as expressed below:

NOTE: Not more than 2 corners, all in the same town and range, may be recorded on this certificate.

	A	B	C	D	E	F	G	H	I	J	K	L	M
1													
2	6		5		4		3		2		1		
3													
4	7		8		9		10		11		12		
5													
6	18		17		16		15		14		13		
7													
8	19		20		21		22		23		24		
9													
10	30		29		28		27		26		25		
11													
12	31		32		33		34		35		36		
13													

SURVEY & REMONUMENTATION

JAN 15 1999

SECTION

- A. Description of original monument and accessories and/or subsequent restoration:
- A-2 GLO Notes - Hemlock 18 N44W 25; Fir Tree 8 S411/2W 8
 - Old Survey Liber - None
 - L.C.R.C. - None
 - Road Comm - None
 - Unrecorded survey dated 4-10-96
 - Act 132 - None

B. Description of corner evidence found and/or method applied in restoring or reestablishing corner:

A - 2
W 1/4 Corner Section 6 T13N-R16E
Found 1/2 Iron Bar in Gravel Road Bed
North 2649.56 feet to the NW Corner Section 6
South 2649.10 feet to the SW Corner Section 6
Accepted as best evidence

APPROVED PEER BOARD MEETING
NOV 30, 1998

C. Description of monument for corner and accessories established to perpetuate locating the position of the corner:

A - 2
W 1/4 Corner Section 6 T13N-R16E
1/2" Iron Bar in Gravel Road Bed with Cap
North 2649.56 feet to the NW Corner Section 6
South 2649.10 feet to the SW Corner Section 6
N30°W 39.60 feet to the North End of a CMP
N40°E 68.55 feet to a nail in a Power Pole
N80°W 20.20 feet to the South End of a CMP
S80°W 45.60 feet to a nail in a Wooden Fence Post

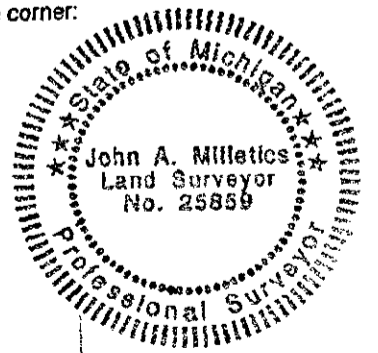

Signed by John A. Milletics
Surveyor's Michigan License No. 25859

Date Nov 20, 1998