

REMONUMENTATION

LAND CORNER RECORDATION CERTIFICATE
Filing Requirement of Act 74, Mich. P.A. 1970

LIBER NO. 2 PAGE NO. 275

For corners in

Sanilac Located in: Corner Code #
(County)

- 1. Public Land Survey T 14N R 12E E-13
T ___ R ___
T ___ R ___
T ___ R ___
- 2. Property Controlling S ___ T ___ R ___
in Section S ___ T ___ R ___
- 3. Miscellaneous S ___ T ___ R ___
Property in Sec. S ___ T ___ R ___

MICHELE VANNORMAN
REGISTER OF DEEDS
SANILAC CO., MICHIGAN

Register of Deeds Stamp & File Number

4. Lot No. _____, Recorded Plat _____
5. Private Claims _____

I, John A. Milletics, in a field survey on Nov 1, 19 98 do hereby state that under requirements of P.A. 74, Michigan P.A. of 1970, the corner points mentioned in lines 1 and 2 above were in conformance with regulations and rules therefore as required in the current manual of survey instructions of the United States Department of the Interior, Bureau of Land Management or by a decree of a Court of Law and/or that the corner points mentioned in lines 3, 4 and 5 above were in conformance with the rules of the Michigan Board of Land Surveyors or by a Decree of a Court of Law; established, re-established, monumented, recovered, found as expressed below:

NOTE: Not more than 2 corners, all in the same town and range, may be recorded on this certificate.

	A	B	C	D	E	F	G	H	I	J	K	L	M
1													
2	6		5		4		3		2		1		
3													
4	7		8		9		10		11		12		
5													
6	10		17		16		15		14		13		
7													
8	19		20		21		22		23		24		
9													
10	30		29		28		27		26		25		
11													
12	31		32		33		34		35		36		
13													

A. Description of original monument and accessories and/or subsequent restoration:

E-13 GLO Notes - Beech 17 N58E 43; Hemlock 16 N54W 20
Old Survey Liber - None
Act 132 - None
L.C.R.C. - None
Road Comm - shows iron found during construction of Hoadley Road

B. Description of corner evidence found and/or method applied in restoring or reestablishing corner:

E - 13
SE Cor Section 32 T14N-R12E
Found 1/2" Iron Bar in gravel road lining up with road to north
Accepted as best evidence

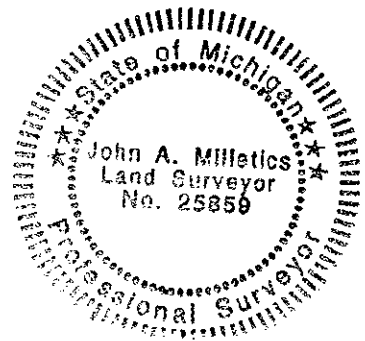

APPROVED PEER BOARD MEETING
NOV 30, 1998

gm

C. Description of monument for corner and accessories established to perpetuate locating the position of the corner:

E-13
SE Corner Section 32 T14N-R12E
1/2" Iron Bar with cap
N20°E 48.70 feet to a Bell Box
S35°E 60.50 feet to a nail in a Power Pole
S10°W 54.20 feet to a nail in a Power Pole
S45°W 99.85 feet to a nail in a Power Pole
West 2637.50 feet to the S 1/4 Corner Section 32
East 2648.00 feet to the S 1/4 Corner Section 33

SURVEY &
REMONUMENTATION

JAN 15 1999

SECTION

Signed by John A. Milletics
Surveyor's Michigan License No. 25859

Date Nov 20, 1998