

98 DEC -1 AM 9:10

REMONUMENTATION

LAND CORNER RECORDATION CERTIFICATE

Filing Requirement of Act 74, Mich. P.A. 1970 LIBER NO. 2 PAGE NO. 276

For corners in

Sanilac (County)	Located In:	Corner Code #
1. Public Land Survey	T14N R12E	F-13
	T R	
	T R	
	T R	
2. Property Controlling in Section	S T R	
	S T R	
3. Miscellaneous Property in Sec.	S T R	
	S T R	

MICHELE VAN NORMAN
REGISTER OF DEEDS
SANILAC CO., MICHIGAN

Register of Deeds Stamp & File Number

4. Lot No. _____, Recorded Plat _____
5. Private Claims _____

I, John A. Milletics, in a field survey on Nov 1, 19 98 do hereby state that under requirements of P.A. 74, Michigan P.A. of 1970, the corner points mentioned in lines 1 and 2 above were in conformance with regulations and rules therefore as required in the current manual of survey instructions of the United States Department of the Interior, Bureau of Land Management or by a decree of a Court of Law and /or that the corner points mentioned in lines 3, 4 and 5 above were in conformance with the rules of the Michigan Board of Land Surveyors or by a Decree of a Court of Law; established, re-established, monumented, recovered, found as expressed below:

NOTE: Not more than 2 corners, all in the same town and range, may be recorded on this certificate.

	A	B	C	D	E	F	G	H	I	J	K	L	M
1													
2	6		5		4		3		2		1		
3													
4	7		8		9		10		11		12		
5													
6	10		17		16		15		14		13		
7													
8	19		20		21		22		23		24		
9													
10	30		29		28		27		26		25		
11													
12	31		32		33		34		35		36		
13													

A. Description of original monument and accessories and/or subsequent restoration:

F-13 GLO Notes - Hemlock 14 N68E 20; Hemlock 10 N68 1/2W 17
Old Survey Liber - None
L.C.R.C. - None
Act 132 - Liber 4 Page 34 Robert Kay
Liber 4 Page 445 Stewart Case
Road Comm - None

B. Description of corner evidence found and/or method applied in restoring or reestablishing corner:

F - 13
S 1/4 Corner Section 33 T14N-R12E
Found 1/2" Iron Bar in Gravel Road Bed
West 2648.00 feet to the SW Corner Section 33
East 2617.00 feet to the SE Corner Section 33
Accepted as best evidence

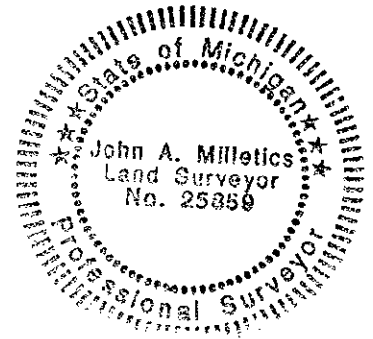

APPROVED PEER BOARD MEETING
NOV 30, 1998

gm

C. Description of monument for corner and accessories established to perpetuate locating the position of the corner:

F- 13
S 1/4 Corner Section 33 T14N-R12E
1/2" Iron cap with cap
North 35.15 feet to a Bell Box
S70°W 84.70 feet to a nail in a wooden fence post
South 31.65 feet to a Metal Fence Post
S45°E 49.80 feet to a Metal Fence Post
West 2648.00 feet to the SW Corner Section 33
East 2617.00 feet to the SE Corner Section 33

SURVEY &
REMONUMENTATION

JAN 15 1999

SECTION

Signed by John A. Milletics
Surveyor's Michigan License No. 25859

Date Nov 20, 1998