

REMONUMENTATION

LAND CORNER RECORDATION CERTIFICATE

Filing Requirement of Act 74, Mich. P.A. 1970

LIBER NO. 2 PAGE NO. 277

For corners in

Sanilac (County)	Located In:	Corner Code #
1. Public Land Survey	T14N R12E	G-13
	T R	
	T R	
	T R	
2. Property Controlling in Section	S T R	
	S T R	
3. Miscellaneous Property in Sec.	S T R	
	S T R	

MICHELE VANNORMAN  
REGISTER OF DEEDS  
SANILAC CO., MICHIGAN

Register of Deeds Stamp & File Number

4. Lot No. \_\_\_\_\_, Recorded Plat \_\_\_\_\_  
5. Private Claims \_\_\_\_\_

I, John A. Millettics, in a field survey on Nov 1, 1998 do hereby state that under requirements of P.A. 74, Michigan P.A. of 1970, the corner points mentioned in lines 1 and 2 above were in conformance with regulations and rules therefore as required in the current manual of survey instructions of the United States Department of the Interior, Bureau of Land Management or by a decree of a Court of Law and/or that the corner points mentioned in lines 3, 4 and 5 above were in conformance with the rules of the Michigan Board of Land Surveyors or by a Decree of a Court of Law; established, re-established, monumented, recovered, found as expressed below:

NOTE: Not more than 2 corners, all in the same town and range, may be recorded on this certificate.

	A	B	C	D	E	F	G	H	I	J	K	L	M
1													
2	6		5		4		3		2		1		
3													
4	7		8		9		10		11		12		
5													
6	18		17		16		15		14		13		
7													
8	19		20		21		22		23		24		
9													
10	30		29		28		27		26		25		
11													
12	31		32		33		34		35		36		
13													

A. Description of original monument and accessories and/or subsequent restoration:

G-13 GLO Notes - Hemlock 10 N60W 17 1/2; Birch 11 N22E 18  
Old Survey Liber - None  
L.C.R.C. - None  
Act 132 - Liber 4, Page 445 (Case)  
Liber 4, Page 34 (Kay)  
Road Comm - None

B. Description of corner evidence found and/or method applied in restoring or reestablishing corner:

G - 13  
SE Corner Section 33 T14N-R12E  
Found 1/2" Iron Bar in gravel road bed  
West 2617.00 feet to the S 1/4 Corner Section 33  
East 2653.58 feet to the S 1/4 Corner Section 34  
Accepted as best evidence

APPROVED PEER BOARD MEETING  
NOV 30, 1998

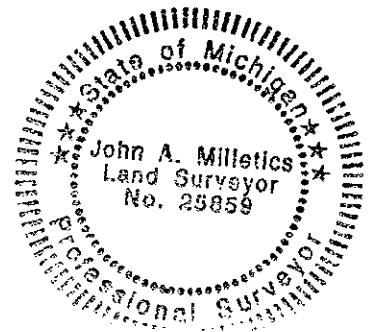

C. Description of monument for corner and accessories established to perpetuate locating the position of the corner:

G - 13  
SE Corner Section 33 T14N-R12E  
1/2" Iron Bar with Cap  
West 70.90 feet to a 1 1/2" Iron Bar in Gravel Road Bed  
N05°W 32.0 feet to a Bell Box  
S50°W 64.0 feet to a Stop Sign  
N80°W 68.55 feet to the East Leg of a Road Sign  
West 2617.00 feet to the S 1/4 Corner Section 33  
East 2653.58 feet to the S 1/4 Corner Section 34

SURVEY &  
REMONUMENTATION

JAN 15 1999

SECTION

Signed by John A. Millettics  
Surveyor's Michigan License No. 25859

Date Nov 20, 1998