

RECEIVED FOR RECORD

REMONUMENTATION

LAND CORNER RECORDATION CERTIFICATE  
Filing Requirement of Act 74, Mich. P.A. 1970

98 DEC - 1 AM 9:09

For corners in

Sanilac  
(County)

Located in:

Corner Code #

1. Public Land Survey

T 14 N R15 E E-13

T \_\_\_\_\_ R \_\_\_\_\_

T \_\_\_\_\_ R \_\_\_\_\_

T \_\_\_\_\_ R \_\_\_\_\_

2. Property Controlling in Section

S \_\_\_\_\_ T \_\_\_\_\_ R \_\_\_\_\_

S \_\_\_\_\_ T \_\_\_\_\_ R \_\_\_\_\_

3. Miscellaneous Property in Sec.

S \_\_\_\_\_ T \_\_\_\_\_ R \_\_\_\_\_

S \_\_\_\_\_ T \_\_\_\_\_ R \_\_\_\_\_

LIBER NO. 2 PAGE NO. 249

MICHELE VANNORMAN  
REGISTER OF DEEDS  
SANILAC CO., MICHIGAN

Register of Deeds Stamp & File Number

4. Lot No. \_\_\_\_\_, Recorded Plat \_\_\_\_\_

5. Private Claims \_\_\_\_\_

I, John A. Milletics, in a field survey on Oct 19, 1998 do hereby state that under requirements of P.A. 74, Michigan P.A. of 1970, the corner points mentioned in lines 1 and 2 above were in conformance with regulations and rules therefore as required in the current manual of survey instructions of the United States Department of the Interior, Bureau of Land Management or by a decree of a Court of Law and/or that the corner points mentioned in lines 3, 4 and 5 above were in conformance with the rules of the Michigan Board of Land Surveyors or by a Decree of a Court of Law; established, re-established, monumented, recovered, found as expressed below:

NOTE: Not more than 2 corners, all in the same town and range, may be recorded on this certificate.

	A	B	C	D	E	F	G	H	I	J	K	L	M
1													
2	6		5		4		3		2		1		
3													
4	7		8		9		10		11		12		
5													
6	18		17		16		15		14		13		
7													
8	19		20		21		22		23		24		
9													
10	30		29		28		27		26		25		
11													
12	31		32		33		34		35		36		
13													

A. Description of original monument and accessories and/or subsequent restoration:

- E-13 GLO Notes - Pine 24 N43W 9 1/2; Pine 40 N40E 47
- Old Survey Liber - None
- Road Comm - None
- L.C.R.C. - None
- Act 132 - None
- Unrecorded Survey - dated 3-22-95

SURVEY &  
REMONUMENTATION

JAN 15 1999

SECTION

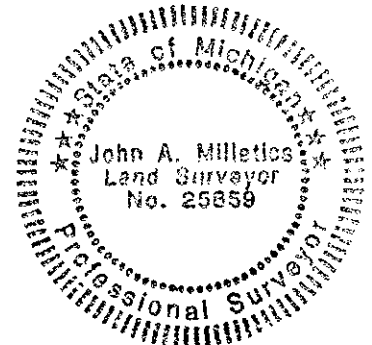

B. Description of corner evidence found and/or method applied in restoring or reestablishing corner:

- E-13
- SE Corner Section 32 T14N-R15E
- Found 3/4 Pipe in gravel road bed
- Accepted as best evidence
- West 2651.50 feet to the S 1/4 Corner Section 32
- East 2657.94 feet to the S 1/4 Corner Section 33

APPROVED PEER BOARD MEETING  
NOV 30, 1998

C. Description of monument for corner and accessories established to perpetuate locating the position of the corner:

- E-13
- SE Corner Section 32 T14N-R15E
- 3/4" Iron Pipe
- East 2657.94 feet to the S 1/4 Corner Section 33
- West 2651.50 feet to the S 1/4 Corner Section 33
- N10°E 36.95 feet to a stop sign
- N60°E 75.25 feet to a nail in a Power Pole
- S05°E 29.50 feet to a cable warning post
- S40°W 98.90 feet to a nail in a Power Pole

Signed by John A. Milletics  
Surveyor's Michigan License No. 25859

Date Nov 19, 98