

98 DEC -1 AM 9:09

REMONUMENTATION

LAND CORNER RECORDATION CERTIFICATE
Filing Requirement of Act 74, Mich. P.A. 1970

LIBER NO. 2 PAGE NO. 259

For corners in

MICHELE VANNORMAN
REGISTER OF DEEDS
SANILAC CO., MICHIGAN

Sanilac (County)	Located In:	Corner Code #
1. Public Land Survey	T14N R16E	C-13
	T___ R___	_____
	T___ R___	_____
	T___ R___	_____
2. Property Controlling in Section	S___ T___ R___	_____
	S___ T___ R___	_____
3. Miscellaneous Property in Sec.	S___ T___ R___	_____
	S___ T___ R___	_____

Register of Deeds Stamp & File Number

4. Lot No. _____, Recorded Plat _____
5. Private Claims _____

I, John A. Milletics, in a field survey on Oct 20, 19 98 do hereby state that under requirements of P.A. 74, Michigan P.A. of 1970, the corner points mentioned in lines 1 and 2 above were in conformance with regulations and rules therefore as required in the current manual of survey instructions of the United States Department of the Interior, Bureau of Land Management or by a decree of a Court of Law and /or that the corner points mentioned in lines 3, 4 and 5 above were in conformance with the rules of the Michigan Board of Land Surveyors or by a Decree of a Court of Law; established, re-established, monumented, recovered, found as expressed below:

NOTE: Not more than 2 corners, all in the same town and range, may be recorded on this certificate.

	A	B	C	D	E	F	G	H	I	J	K	L	M
1													
2	6		5		4		3		2		1		
3													
4	7		8		9		10		11		12		
5													
6	18		17		16		15		14		13		
7													
8	19		20		21		22		23		24		
9													
10	30		29		28		27		26		25		
11													
12	31		32		33		34		35		36		
13													

A. Description of original monument and accessories and/or subsequent restoration:

- 13 GLO Notes - Beech 12 N36 1/2W 13; Beech 10 N57 1/2E 7 1/2
- Old Survey Liber - Survey by J.W. Galbraith dated 1893
- L.C.R.C. - None
- Act 123 - None
- Road Comm - None
- Unrecorded survey dated 11-21-94

B. Description of corner evidence found and/or method applied in restoring or reestablishing corner:

C - 13
SE Corner Section 31 T14N-R16E
Found 3/4" Iron Pile
Accepted as best evidence

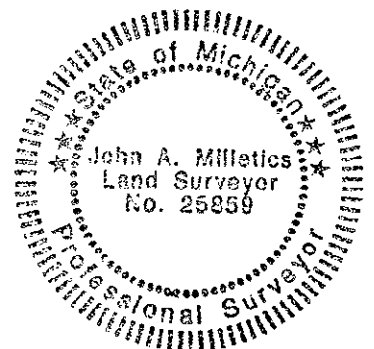

APPROVED PEER BOARD MEETING
NOV 30, 1998

C. Description of monument for corner and accessories established to perpetuate locating the position of the corner:

C - 13
SE Corner Section 31 T14N-R16E
3/4" Iron Pipe
West 17.90 feet to a 1/2" iron bar in road bed
West 2640.10 feet to the S 1/4 Corner Section 31
East 2640.20 feet to the S 1/4 Corner Section 32
N45°W 51.90 feet to a nail in a 18' Birch
N30°E 72.65 feet to a nail in a 24" Cedar
N45°E 53.10 feet to a nail in a Power Pole

SURVEY &
REMONUMENTATION

JAN 15 1999

SECTION

Signed by John A. Milletics
Surveyor's Michigan License No. 25859

Date Nov 20, 1998