



MAR 16 1999

LAND CORNER RECORDATION CERTIFICATE
Filing Requirement of Act 74, Mich. P.A. 1970

SECTION

	Located In:	Corner Code #
	China Township	
1. Public Land Survey	T <u>4N</u> R <u>16E</u>	<u>A-13</u>
	T _____ R _____	_____
2. Property Controlling S _____ T _____ R _____	S _____ T _____ R _____	_____
in Section	S _____ T _____ R _____	_____
3. Miscellaneous S _____ T _____ R _____	S _____ T _____ R _____	_____
Property in Sec.	S _____ T _____ R _____	_____

RECEIVED
MADRYN DUNN
1998 DEC 30 PM 12:13
REGISTER OF DEEDS
ST. CLAIR COUNTY
LIBER _____ PG _____

Register of Deeds Stamp & File Number

4. Lot No. _____, Recorded Plat _____
5. Private Claims _____

I, John C. Niederhauser, in a field survey on September 22, 1998, do hereby certify that under requirements of P.A. 74, Michigan P.A. of 1970, the corner points mentioned in lines 1 and 2 above were in conformance with regulations and rules therefore as required in the current manual of survey instructions of the United States Department of the Interior, Bureau of Land Management or by a decree of a Court of Law and/or that the corner points mentioned in lines 3, 4 and 5 above were in conformance with the rules of the Michigan Board of Land Surveyors or by a Decree of a Court of Law; established, re-established, monumented, re-monumented, recovered, found as expressed below:

	A	B	C	D	E	F	G	H	I	J	K	L	M
2	6	5	4	3	2	1							
3													
4	7	8	9	10	11	12							
5													
6	18	17	16	15	14	13							
7													
8	19	20	21	22	23	24							
9													
10	30	29	28	27	26	25							
11													
12	31	32	33	34	35	36							
13													

NOTE: Not more than 1 CORNER, may be recorded on this certificate.

A. Description of original monument and accessories and/or subsequent restoration:

Wood post set as original corner by William Preston in May 1817. This is a Township corner and is common to corners M-1 of T3N-R15E, A-1 of T3N-R16E and M-13 of T4N-R15E. Old County Surveyors Records lists corner witnesses but does not describe type of monumentation. Lloyd Thomas recovers and records a P.K. nail, October 1972, see Liber 1, page 476. John Lansky recovers and records P.K. nail with cap, October 1976, see Liber 3, page 358. Robert Kreger found a 1" pipe and raised with monument box, August 9, 1988, see Liber 6, page 82. Jack Lansky recovers and records a found iron pipe in a monument box February 1997, see Liber 9, page 3.

B. Description of corner evidence found and/or method applied in restoring or reestablishing corner:

Found a 3/4" iron pipe in a monument box on the centerline of pavement of Marine City Highway and the approximate center of Mayer Road (unimproved both north and south). Verified corner using previously recorded witnesses and reference distances on corner certificates: Liber 6, page 82; Liber 9, page 3; and Liber 3, page 358. Measured west to SW corner Section 36 of T4N-R15E, 2,694.54' (R), 2,694.51' (M). Measured south to west 1/4 corner Section 6 of T3N-R16E; 2,685.00' (R), 2,685.02' (M). Measured east to north 1/4 corner Section 6 of T3N-R16E; 2,712.16' (R), 2,712.28' (M).

C. Description of monument for corner and accessories established to perpetuate locating the position of the corner:

Set a 2" diameter aluminum cap with a magnet attached, inscribed "St. Clair County Official Corner", placed on a 1/2" diameter rod. Both placed over the existing 3/4" diameter pipe in the existing monument box. Located at the GLO Township corner and is common to corners: A-1 of T3N-R16E, M-1 of T3N-R15E and M-13 of T4N-R15E.

- N 25°E 84.20' to set P.K. nail with SCC Remon. washer in the NW side of a 12" Elm Tree.
- N 25°W 65.13' to set P.K. nail with SCC Remon. washer in SW side of a Utility Pole.
- S 65°W 80.34' to set P.K. nail with SCC Remon washer in SE side of Telephone Pole.
- S 55°W 40.58' to a cut "X" in top of the east end of the south concrete headwall of box culvert.

Signed by John C. Niederhauser
Surveyor's Michigan License No. 24608

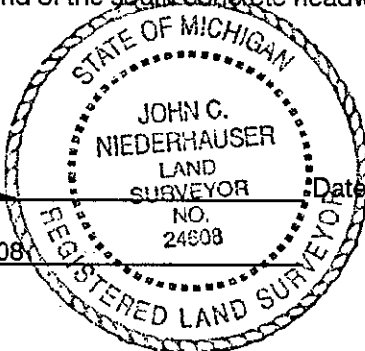

Date December 4, 1998

PA 345-1990
PEER COMMITTEE
APPROVED DEC. 15, 1998