

ST. CLAIR COUNTY, MICHIGAN OFFICIAL GOVERNMENT CORNER



LAND CORNER RECORDATION CERTIFICATE Filing Requirement of Act 74, Mich. P.A. 1970

	Located In:	Corner Code #
	Berlin Twp.	F-1
	6N 13E	
1. Public Land Survey	T _____ R _____	_____
	T _____ R _____	_____
	T _____ R _____	_____
	T _____ R _____	_____
2. Property Controlling in Section	S _____ T _____ R _____	<i>Seg. #2</i>
	S _____ T _____ R _____	_____
3. Miscellaneous Property in Sec.	S _____ T _____ R _____	_____
	S _____ T _____ R _____	_____

Register of Deeds Stamp & File Number

1995 APR -4 11 10 12
REGISTERED
REGISTERED
REGISTERED

4. Lot No. _____, Recorded Plat _____

5. Private Claims _____

I, **Daniel E. Johnson**, in a field survey on **February 7,** 19**95**, do hereby certify that under requirements of P.A. 74, Michigan P.A. of 1970, the corner points mentioned in lines 1 and 2 above were in conformance with regulations and rules therofore as required in the current manual of survey instructions of the United States Department of the Interior, Bureau of Land Management or by a decree of a Court of Law and/or that the corner points mentioned in lines 3, 4 and 5 above were in conformance with the rules of the Michigan Board of Land Surveyors or by a Decree of a Court of Law; established, re-established, monumented, re-monumented, recovered, found as expressed below:

A	B	C	D	E	F	G	H	I	J	K	L	M
2	6	5	4	3	2	1						
3												
4	7	8	9	10	11	12						
5												
6	16	17	16	15	14	13						
7												
8	19	20	21	22	23	24						
9												
10	30	29	28	27	26	25						
11												
12	31	32	33	34	35	36						
13												

NOTE: Not more than 1 corner, may be recorded on this certificate.

A. Description of original monument and accessories and/or subsequent restoration:

LIBER 007 PAGE 267

STATE PLAIN COORDINATES

N. _____

E. _____

B. Description of corner evidence found and/or method applied in restoring or reestablishing corner:

LIBER 007 PAGE 267

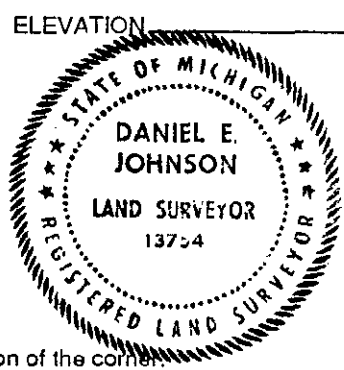

C. Description of monument for corner and accessories established to perpetuate locating the position of the corner:

Set with 2" dia. aluminum cap inscribed "St. Clair County Official Corner" with magnet.
on a
3/4" Square Rod. (1.64' North of line between section corners S $\frac{1}{2}$ 33, SE 33, T.7N., R.13E.)
76.03' S to set P.K. in County Tag in 18" Elm.
318.51' ENE to set P.K. in County Tag in 42" Oak.
250.55' NW to set P.K. in County Tag in 10" Elm.
458.46' ESE to set P.K. in County Tag in 12" Poplar.

Signed by *Daniel E. Johnson* Date February 7, 1995
Daniel E. Johnson
Surveyor's Michigan License No. 13754

PA 345-1990
PEER COMMITTEE
APPROVED 6-17-94
7-25-95
Date
LIBER 100

APPROVED AS AN OFFICIAL GOVERNMENT CORNER BY ST. CLAIR COUNTY:

Signed By: *Daniel E. Johnson*
St. Clair County Land Surveyor Daniel e. Johnson
13754