

ST. CLAIR COUNTY, MICHIGAN OFFICIAL GOVERNMENT CORNER



LAND CORNER RECORDATION CERTIFICATE Filing Requirement of Act 74, Mich. P.A. 1970

	Located In:	Corner Code #	
	Berlin Twp.		
1. Public Land Survey	6N 13E	I-1	
	T ___ R ___	_____	
	T ___ R ___	_____	
	T ___ R ___	_____	
	T ___ R ___	_____	
2. Property Controlling in Section	S ___ T ___ R ___	<i>Seg. #2</i>	
	S ___ T ___ R ___	_____	
3. Miscellaneous Property in Sec.	S ___ T ___ R ___	_____	
	S ___ T ___ R ___	_____	

REGISTERED
1995 Aug - 11 11:10:11
RECEIVED
Register of Deeds Stamp & File Number

4. Lot No. _____, Recorded Plat _____
5. Private Claims _____

Daniel E. Johnson February 7, 95

I, _____, in a field survey on _____, 19 _____, do hereby certify that under requirements of P.A. 74, Michigan P.A. of 1970, the corner points mentioned in lines 1 and 2 above were in conformance with regulations and rules therefore as required in the current manual of survey instructions of the United States Department of the Interior, Bureau of Land Management or by a decree of a Court of Law and/or that the corner points mentioned in lines 3, 4 and 5 above were in conformance with the rules of the Michigan Board of Land Surveyors or by a Decree of a Court of Law; established, re-established, monumented, re-monumented, recovered, found as expressed below:

	A	B	C	D	E	F	G	H	I	J	K	L	M
2	6	5	4	3	2	1							
3													
4	7	8	9	10	11	12							
5													
6	18	17	16	15	14	13							
7													
8	19	20	21	22	23	24							
9													
10	30	29	28	27	26	25							
11													
12	31	32	33	34	35	36							
13													

NOTE: Not more than 1 corner, may be recorded on this certificate.

A. Description of original monument and accessories and/or subsequent restoration:
LIBER 007 PAGE 261

STATE PLAIN COORDINATES

N. _____

E. _____

ELEVATION _____

B. Description of corner evidence found and/or method applied in restoring or reestablishing corner:
LIBER 007 PAGE 261

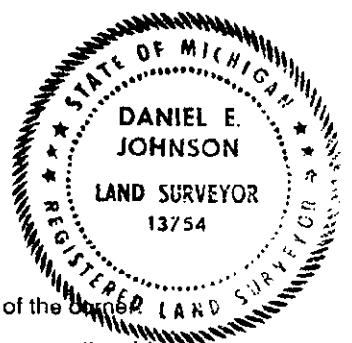

C. Description of monument for corner and accessories established to perpetuate locating the position of the corner:
Set 2" dia. aluminum cap inscribed "St. Clair County Official Corner" with magnet
on a
3/4" Iron Bar. (1.11' North of line between sec. corners, SW35, S435, T. 7N. R. 13E.)
Set short 1/2 R Bar With Cap #24615 above.

44.21' NE to set P.K. and County Tag in Underground Tele Support Post.
Above spike in MDSH Tag.

127.31' NW to set P.K. and County Tag in P.Pole.
253.28' SW to set P.K. and County Tag in P.Pole.
202.65' NE to set P.K. and County Tag in P.Pole.

Signed by *Daniel E. Johnson* Date February 7, 1995
Daniel E. Johnson
Surveyor's Michigan License No. 13754

PA 345-1990
PEER COMMITTEE
APPROVED 6-17-94 *Daniel*

APPROVED AS AN OFFICIAL GOVERNMENT CORNER BY ST. CLAIR COUNTY:

Signed By: *Daniel E. Johnson* Date JULY 25, 1995
St. Clair County Land Surveyor Daniel E. Johnson
13754 Date

11RF2 008 71