

# ST. CLAIR COUNTY, MICHIGAN OFFICIAL GOVERNMENT CORNER



## LAND CORNER RECORDATION CERTIFICATE Filing Requirement of Act 74, Mich. P.A. 1970

	Located In: Wales Twp.	Corner Code #	
1. Public Land Survey	T <u>6N</u> R <u>15E</u>	C-1	
	T _____ R _____		
	T _____ R _____		
	T _____ R _____		
2. Property Controlling in Section	S _____ T _____ R _____	<i>Seg 2</i>	
	S _____ T _____ R _____		
3. Miscellaneous Property in Sec.	S _____ T _____ R _____		
	S _____ T _____ R _____		

RECEIVED  
REGISTERED  
1995 APR -17 AM 10:27

**Register of Deeds Stamp & File Number**

4. Lot No. \_\_\_\_\_, Recorded Plat \_\_\_\_\_  
5. Private Claims \_\_\_\_\_

	A	B	C	D	E	F	G	H	I	J	K	L	M
2	6		5		4		3		2		1		
3													
4	7		8		9		10		11		12		
5													
6	18		17		16		15		14		13		
7													
8	19		20		21		22		23		24		
9													
10	30		29		28		27		26		25		
11													
12	31		32		33		34		35		36		
13													

I, Daniel E. Johnson in a field survey on April 17, 19 95 do hereby certify that under requirements of P.A. 74, Michigan P.A. of 1970, the corner points mentioned in lines 1 and 2 above were in conformance with regulations and rules therefore as required in the current manual of survey instructions of the United States Department of the Interior, Bureau of Land Management or by a decree of a Court of Law and/or that the corner points mentioned in lines 3, 4 and 5 above were in conformance with the rules of the Michigan Board of Land Surveyors or by a Decree of a Court of Law; established, re-established, monumented, re-monumented, recovered, found as expressed below:

**NOTE: Not more than 1 corner, may be recorded on this certificate.**

A. Description of original monument and accessories and/or subsequent restoration:

LIBER 007 PAGE 180

STATE PLAIN COORDINATES

N. \_\_\_\_\_

E. \_\_\_\_\_

ELEVATION \_\_\_\_\_

B. Description of corner evidence found and/or method applied in restoring or reestablishing corner:

LIBER 007 PAGE 180

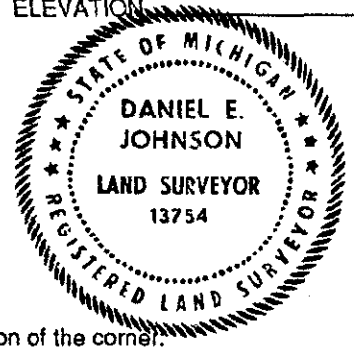

C. Description of monument for corner and accessories established to perpetuate locating the position of the corner:

Set a 2" dia aluminum cap inscribed " St. Clair County Official Corner " with magnet on a "T" iron.  
 NE 126.10' to set PK and County Tag in W face of 60" Maple.  
 S 52.48' to set PK and County Tag in E face of 18" Maple.  
 WSW 33.10' to set PK and County Tag in N face of 10" Poplar.  
 ESE 47.30' to set PK and County Tag in N face of 18" Twin Maple.

Signed by *Daniel E. Johnson* Date April 17, 1995  
 Daniel E. Johnson 13754  
 Surveyor's Michigan License No. \_\_\_\_\_

PA 345-1990  
PEER COMMITTEE

APPROVED 12-14-93 *Dude*

APPROVED AS AN OFFICIAL GOVERNMENT CORNER BY ST. CLAIR COUNTY:

Signed By: *Daniel E. Johnson* : 7-31-95  
 Daniel E. Johnson  
 St. Clair County Land Surveyor 13754

Date

Surveyor's Michigan License No. \_\_\_\_\_

LIBER 008 PAGE 209