

ST. CLAIR COUNTY, MICHIGAN OFFICIAL GOVERNMENT CORNER



LAND CORNER RECORDATION CERTIFICATE Filing Requirement of Act 74, Mich. P.A. 1970

Located In: _____ Corner Code # _____

	Wales Twp.		
1. Public Land Survey	T <u>6N.</u> R <u>15E.</u>	M-3	_____
	T _____ R _____	_____	_____
	T _____ R _____	_____	_____
	T _____ R _____	_____	_____
2. Property Controlling in Section	S _____ T _____ R _____	<i>Sec. 2</i>	_____
	S _____ T _____ R _____	_____	_____
3. Miscellaneous Property in Sec.	S _____ T _____ R _____	_____	_____
	S _____ T _____ R _____	_____	_____

RECEIVED
 REGISTERED LAND SURVEYORS
 ST. CLAIR COUNTY
 JUN 23 4 11 10: 26

Register of Deeds Stamp & File Number

4. Lot No. _____, Recorded Plat _____
 5. Private Claims _____

	A	B	C	D	E	F	G	H	I	J	K	L	M
2	6	5	4	3	2	1							
3													
4	7	8	9	10	11	12							
5													
6	18	17	16	15	14	13							
7													
8	19	20	21	22	23	24							
9													
10	30	29	28	27	26	25							
11													
12	31	32	33	34	35	36							
13													

I, Daniel E. Johnson, in a field survey on June 23, 1995, do hereby certify that under requirements of P.A. 74, Michigan P.A. of 1970, the corner points mentioned in lines 1 and 2 above were in conformance with regulations and rules therefore as required in the current manual of survey instructions of the United States Department of the Interior, Bureau of Land Management or by a decree of a Court of Law and/or that the corner points mentioned in lines 3, 4 and 5 above were in conformance with the rules of the Michigan Board of Land Surveyors or by a Decree of a Court of Law; established, re-established, monumented, re-monumented, recovered, found as expressed below:

NOTE: Not more than 1 corner, may be recorded on this certificate.

A. Description of original monument and accessories and/or subsequent restoration:

LIBER 007 PAGE 130

STATE PLAIN COORDINATES

N. _____

E. _____

ELEVATION _____

B. Description of corner evidence found and/or method applied in restoring or reestablishing corner:

LIBER 007 PAGE 130

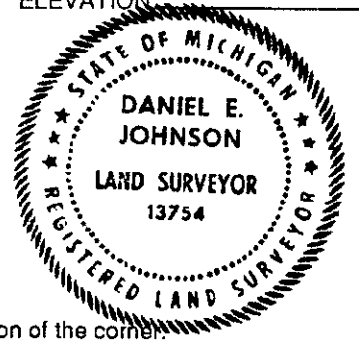

C. Description of monument for corner and accessories established to perpetuate locating the position of the corner:
 Set 1/2" x 42" Rebar with 2" dia. aluminum cap inscribed "St. Clair County Official Corner" with magnet on a 3/4" Iron Pipe (Old)
 N.N.W 7.85 ft. Set PK Nail & Tag in 24" Oak
 Southerly 18.35 ft. Set PK Nail & Tag in 18" Black Cherry
 N.E.'ly 28.00 ft. Set PK Nail & Tag in 12" Oak
 Southerly 25.70 to MDOT Cap on 1/2" pipe at N.W. Corner of Sec. 7, T.6N., R.16E.,

Signed by Daniel E. Johnson Date June 23, 1995
 Daniel E. Johnson
 Surveyor's Michigan License No. 13754

PA 345-1990
 PEER COMMITTEE

APPROVED AS AN OFFICIAL GOVERNMENT CORNER BY ST. CLAIR COUNTY:
 Signed By: Daniel E. Johnson : 7-31-95 Date _____
 St. Clair County Land Surveyor Daniel E. Johnson
 Surveyor's Michigan License No. 13754

LIBER 008 PAGE 196