

RECEIVED ST. CLAIR COUNTY, MICHIGAN
OFFICIAL GOVERNMENT CORNER



1994 SEP 20 PM 2:24

LAND CORNER RECORDATION CERTIFICATE
Filing Requirement of Act 74, Mich. P.A. 1970

REGISTERED LAND SURVEYOR
ST. CLAIR COUNTY

Located In: Corner Code #
Kimball Township

- | | | |
|------------------------------------|--------------------------|---------------|
| 1. Public Land Survey | T <u>6N</u> R <u>16E</u> | <u>A-2</u> |
| | T _____ R _____ | _____ |
| | T _____ R _____ | _____ |
| | T _____ R _____ | _____ |
| 2. Property Controlling in Section | S _____ T _____ R _____ | <u>Sec. 1</u> |
| | S _____ T _____ R _____ | _____ |
| 3. Miscellaneous Property in Sec. | S _____ T _____ R _____ | _____ |
| | S _____ T _____ R _____ | _____ |

Register of Deeds Stamp & File Number

4. Lot No. _____, Recorded Plat _____
5. Private Claims _____

I, John C. Niederhauser, in a field survey on July 28, 19 94, do hereby certify that under requirements of P.A. 74, Michigan P.A. of 1970, the corner points mentioned in lines 1 and 2 above were in conformance with regulations and rules therefore as required in the current manual of survey instructions of the United States Department of the Interior, Bureau of Land Management or by a decree of a Court of Law and/or that the corner points mentioned in lines 3, 4 and 5 above were in conformance with the rules of the Michigan Board of Land Surveyors or by a Decree of a Court of Law; established, re-established, monumented, re-monumented, recovered, found as expressed below:

	A	B	C	D	E	F	G	H	I	J	K	L	M
2	6	5	4	3	2								
3													
4	7	8	9	10	11	12							
5													
6	18	17	16	15	14	13							
7													
8	19	20	21	22	23	24							
9													
10	30	29	28	27	26	25							
11													
12	31	32	33	34	35	36							
13													

NOTE: Not more than 1 corner, may be recorded on this certificate.

A. Description of original monument and accessories and/or subsequent restoration:

This corner was not set during original government survey. Nothing listed on Old Surveyor's Record, St. Clair County. No corner certificates have been filed for this corner. Found iron #19835 on fence line to east and 0.94' west of the True Township line.

STATE PLAIN COORDINATES

N. _____
E. _____

ELEVATION _____

B. Description of corner evidence found and/or method applied in restoring or reestablishing corner:

Set 1/2" rerod with cap #24608. Established corner by running a straight line from the S.W. corner of Section 6, T6N-R16E to the N.W. corner of Section 6, T6N-R16E and setting the iron at the intersection of an Old fence line from the east, normal 0.94' east of a found iron #19835. Old fence remains on the north and south Township line, mostly knocked down.

C. Description of monument for corner and accessories established to perpetuate locating the position of the corner:

Capped 1/2" reod #24608. Located on the True Township line.

- S.S.E. 18.88' to set P.K. nail with county remon tag in W. side 8' oak tree.
- E. 13.33' to set P.K. nail with county remon tag in S. side 10" ash tree.
- N.W. 18.52 to set P.K. nail with county remon tag in E. side 8" ash tree.
- N. 35.87' to set P.K. nail with county remon tag in W. side 24" oak tree.
- S. 2628.48' to S.W. corner Section 6, T6N-R16E
- N. 2785.18' to N.W. corner of Section 6, T6N-R16E

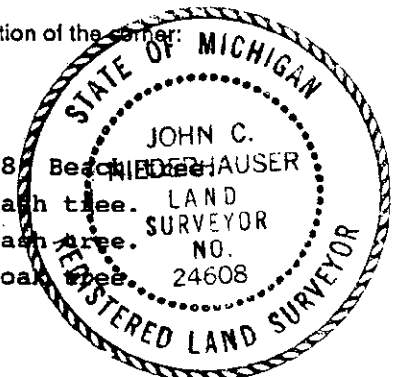

Signed by [Signature] PA 345-1990
John C. Niederhauser PEER COMMITTEE Date July 28, 1994
APPROVED 6-24-94
Surveyor's Michigan License No. 24608

APPROVED AS AN OFFICIAL GOVERNMENT CORNER BY ST. CLAIR COUNTY:

Signed By: _____ : _____
St. Clair County Land Surveyor Date