

# ST. CLAIR COUNTY, MICHIGAN OFFICIAL GOVERNMENT CORNER



## LAND CORNER RECORDATION CERTIFICATE Filing Requirement of Act 74, Mich. P.A. 1970

RECEIVED  
 REGISTERED CLERK OF DEEDS  
 ST. CLAIR COUNTY  
 05 AUG -4 AM 10:18

Located In: \_\_\_\_\_ Corner Code # \_\_\_\_\_

- |                                    |                            |               |       |
|------------------------------------|----------------------------|---------------|-------|
|                                    | Kimball Twp.               |               |       |
| 1. Public Land Survey              | T <u>6N.</u> R <u>16E.</u> | <u>A-13</u>   | _____ |
|                                    | T _____ R _____            | _____         | _____ |
|                                    | T _____ R _____            | _____         | _____ |
|                                    | T _____ R _____            | _____         | _____ |
| 2. Property Controlling in Section | S _____ T _____ R _____    | <u>Sec. 2</u> | _____ |
|                                    | S _____ T _____ R _____    | _____         | _____ |
| 3. Miscellaneous Property in Sec.  | S _____ T _____ R _____    | _____         | _____ |

Register of Deeds Stamp & File Number

4. Lot No. \_\_\_\_\_, Recorded Plat \_\_\_\_\_
5. Private Claims \_\_\_\_\_

	A	B	C	D	E	F	G	H	I	J	K	L	M
2	6	5	4	3	2	1							
3													
4	7	8	9	10	11	12							
5													
6	18	17	16	15	14	13							
7													
8	19	20	21	22	23	24							
9													
10	30	29	28	27	26	25							
11													
12	31	32	33	34	35	36							
13													

I, Daniel E. Johnson, in a field survey on January 31, 1995

do hereby certify that under requirements of P.A. 74, Michigan P.A. of 1970, the corner points mentioned in lines 1 and 2 above were in conformance with regulations and rules therefore as required in the current manual of survey instructions of the United States Department of the Interior, Bureau of Land Management or by a decree of a Court of Law and/or that the corner points mentioned in lines 3, 4 and 5 above were in conformance with the rules of the Michigan Board of Land Surveyors or by a Decree of a Court of Law; established, re-established, monumented, re-monumented, recovered, found as expressed below:

**NOTE: Not more than 1 corner, may be recorded on this certificate.**

A. Description of original monument and accessories and/or subsequent restoration:

LIBER 007 PAGE 90

STATE PLAIN COORDINATES

N. \_\_\_\_\_

E. \_\_\_\_\_

ELEVATION \_\_\_\_\_

B. Description of corner evidence found and/or method applied in restoring or reestablishing corner:

LIBER 007 PAGE 90

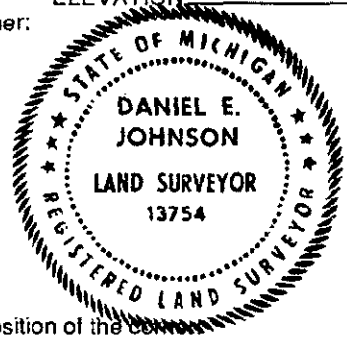

- C. Description of monument for corner and accessories established to perpetuate locating the position of the corner:
- Set 2" dia. aluminum cap inscribed "St. Clair County Official Corner" with magnet on a**  
**CONCRETE MONUMENT WITH IRON ROD INSERTED**  
 N.W. 43.57 Set PK Nail with County Tag in D.E. Pole  
 N.E. 67.8 ft. to center of Sun Pipe Line marker.  
 S.E. 77.4 ft. to N.W. Corner of N/S Conc. Headwall  
 S.W. 77.7 ft. to the N.E. Corner of N/S. Conc. Headwall

Signed by Daniel E. Johnson Date January 31, 1995  
 Daniel E. Johnson  
 Surveyor's Michigan License No. 13754

PA 345-1990  
PEER COMMITTEE

APPROVED AS AN OFFICIAL GOVERNMENT CORNER BY ST. CLAIR COUNTY:  
 Signed By: Daniel E. Johnson : 7-31-95  
 St. Clair County Land Surveyor Daniel E. Johnson  
 13754

APPROVED 11-30-93 *Dave*

Surveyor's Michigan License No. \_\_\_\_\_