

# ST. CLAIR COUNTY, MICHIGAN OFFICIAL GOVERNMENT CORNER



## LAND CORNER RECORDATION CERTIFICATE Filing Requirement of Act 74, Mich. P.A. 1970

Located In: \_\_\_\_\_ Corner Code # \_\_\_\_\_

Clyde Twp.

T 7N. R R16E. I-13  
 T \_\_\_\_\_ R \_\_\_\_\_  
 T \_\_\_\_\_ R \_\_\_\_\_  
 T \_\_\_\_\_ R \_\_\_\_\_  
 S \_\_\_\_\_ T \_\_\_\_\_ R \_\_\_\_\_  
 S \_\_\_\_\_ T \_\_\_\_\_ R \_\_\_\_\_  
 S \_\_\_\_\_ T \_\_\_\_\_ R \_\_\_\_\_  
 S \_\_\_\_\_ T \_\_\_\_\_ R \_\_\_\_\_

1. Public Land Survey

2. Property Controlling  
in Section

3. Miscellaneous  
Property in Sec.

4. Lot No. \_\_\_\_\_, Recorded Plat \_\_\_\_\_

5. Private Claims \_\_\_\_\_

RECEIVED  
 1995 AUG -4 AM 10:13  
 REGISTER OF DEEDS  
 ST. CLAIR COUNTY  
 Register of Deeds Stamp & File Number

**Daniel E. Johnson**                      **May 11,**                      **95**

I, \_\_\_\_\_, in a field survey on \_\_\_\_\_, 19\_\_\_\_, do hereby certify that under requirements of P.A. 74, Michigan P.A. of 1970, the corner points mentioned in lines 1 and 2 above were in conformance with regulations and rules therefore as required in the current manual of survey instructions of the United States Department of the Interior, Bureau of Land Management or by a decree of a Court of Law and/or that the corner points mentioned in lines 3, 4 and 5 above were in conformance with the rules of the Michigan Board of Land Surveyors or by a Decree of a Court of Law; established, re-established, monumented, re-monumented, recovered, found as expressed below:

**NOTE: Not more than 1 corner, may be recorded on this certificate.**

A. Description of original monument and accessories and/or subsequent restoration:

**LIBER 007 PAGE 367**

STATE PLAIN COORDINATES

N. \_\_\_\_\_

E. \_\_\_\_\_

ELEVATION \_\_\_\_\_

B. Description of corner evidence found and/or method applied in restoring or reestablishing corner:

**LIBER 007 PAGE 367**

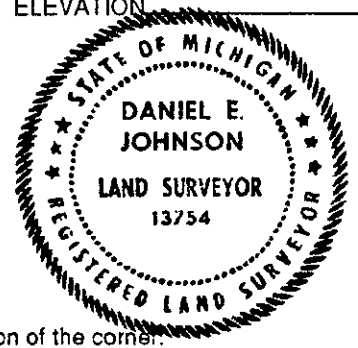

C. Description of monument for corner and accessories established to perpetuate locating the position of the corner:

Set 1/2"x 40" Rebar with 2" dia. aluminum cap inscribed "St. Clair County Official Corner" with magnet on a 1" pinched iron pipe on line w/old E and W fence. Located on the true Township line.  
 WEST 23.75' to set PK nail w/county remon tag in S side 18" Maple Tree  
 EAST 14.05' to set PK nail w/county remon tag in S side 24" Ash Tree  
 N 50°E 12.00' to set PK nail w/county remon tag in SE side 4" Ironwood Tree  
 SOUTH 13.85' to set PK nail w/county remon tag in W side 10" Maple Tree  
 WEST 2654.98' to S 1/4 corner Section 34, T7N-R16E  
 EAST 2620.58' to S 1/4 corner Section 35, T7N-R16E

Signed by \_\_\_\_\_ Date **MAY 11, 1995**

*Daniel E. Johnson*  
Daniel E. Johnson

Surveyor's Michigan License No. **#13754**

PA 345-1990  
PEER COMMITTEE

APPROVED AS AN OFFICIAL GOVERNMENT CORNER BY ST. CLAIR COUNTY:

Signed By: \_\_\_\_\_ : \_\_\_\_\_

St. Clair County Land Surveyor *Daniel E. Johnson*  
Daniel E. Johnson

**7-31-95**

Date

Surveyor's Michigan License No. **#13754**

LIBER **008** PAGE **88**