

ST. CLAIR COUNTY, MICHIGAN OFFICIAL GOVERNMENT CORNER



LAND CORNER RECORDATION CERTIFICATE Filing Requirement of Act 74, Mich. P.A. 1970

Located In: _____ Corner Code #/ _____

Clyde Twp.

- | | | | |
|------------------------------------|----------------------------|-------|---------------|
| 1. Public Land Survey | T <u>7N.</u> R <u>16E.</u> | D-13 | |
| | T _____ R _____ | _____ | _____ |
| | T _____ R _____ | _____ | _____ |
| | T _____ R _____ | _____ | _____ |
| 2. Property Controlling in Section | S _____ T _____ R _____ | | |
| | S _____ T _____ R _____ | | <i>Sec. 2</i> |
| 3. Miscellaneous Property in Sec. | S _____ T _____ R _____ | | |
| | S _____ T _____ R _____ | | |

RECEIVED
 REGISTER OF DEEDS
 ST. CLAIR COUNTY, MICHIGAN
 1995 AUG - 4 AM 10:13

Register of Deeds Stamp & File Number

4. Lot No. _____, Recorded Plat _____
5. Private Claims _____

Daniel E. Johnson **June 23,** **95**

I, _____, in a field survey on _____, 19____ do hereby certify that under requirements of P.A. 74, Michigan P.A. of 1970, the corner points mentioned in lines 1 and 2 above were in conformance with regulations and rules therefore as required in the current manual of survey instructions of the United States Department of the Interior, Bureau of Land Management or by a decree of a Court of Law and/or that the corner points mentioned in lines 3, 4 and 5 above were in conformance with the rules of the Michigan Board of Land Surveyors or by a Decree of a Court of Law; established, re-established, monumented, re-monumented, recovered, found as expressed below:

NOTE: Not more than 1 corner, may be recorded on this certificate.

A. Description of original monument and accessories and/or subsequent restoration:

LIBER 007 PAGE 372

STATE PLAIN COORDINATES

N. _____

E. _____

ELEVATION _____

B. Description of corner evidence found and/or method applied in restoring or reestablishing corner:

LIBER 007 PAGE 372

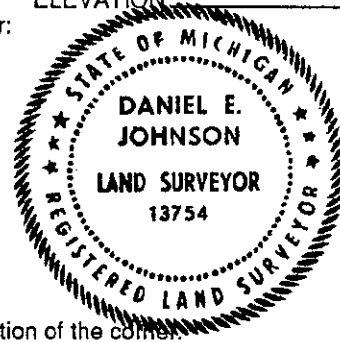

C. Description of monument for corner and accessories established to perpetuate locating the position of the corner:
 Set with 2" dia. aluminum cap inscribed "St. Clair County Official Corner" with magnet (in Monument Box)

on centerline of existing Lapeer Rd. pavement.

- Located on the true Township Line
- S 15°W 54.85' to set PK nail w/county remon tag in NW side of power pole
 - S 30°E 85.64' to set PK nail w/county remon tag in WSW side of 12" Maple Tree
 - N 13°E 50.78' to set PK nail w/county remon tag in E side of old fence post
 - N 72°W 144.57' to set PK nail w/county remon tag in SW side of power pole
 - WEST 2627.51' to SW corner Section 32, T7N-R16E
 - EAST 2636.22' to SE corner Section 32, T7N-R16E

Signed by _____ *Daniel E. Johnson* Date June 23, 1995

Surveyor's Michigan License No. 13754

PA 345-1990
PEER COMMITTEE

APPROVED 6-10-94 *Danf*

APPROVED AS AN OFFICIAL GOVERNMENT CORNER BY ST. CLAIR COUNTY:

Signed By: _____ *Daniel E. Johnson* : 7-31-95

St. Clair County Land Surveyor **Daniel E. Johnson** Date

Surveyor's Michigan License No. 13754

LIBER **008** PAGE **83**