

# ST. CLAIR COUNTY, MICHIGAN OFFICIAL GOVERNMENT CORNER



## LAND CORNER RECORDATION CERTIFICATE Filing Requirement of Act 74, Mich. P.A. 1970

Located In: \_\_\_\_\_ Corner Code # \_\_\_\_\_

**Clyde Twp.**

- |                                    |         |         |         |               |       |
|------------------------------------|---------|---------|---------|---------------|-------|
| 1. Public Land Survey              | T _____ | R _____ | _____   | _____         | _____ |
|                                    | T _____ | R _____ | 7N.     | 16E.          | H-13  |
|                                    | T _____ | R _____ | _____   | _____         | _____ |
|                                    | T _____ | R _____ | _____   | _____         | _____ |
| 2. Property Controlling in Section | S _____ | T _____ | R _____ | <i>Sec. 2</i> |       |
|                                    | S _____ | T _____ | R _____ |               |       |
|                                    | S _____ | T _____ | R _____ |               |       |
| 3. Miscellaneous Property in Sec.  | S _____ | T _____ | R _____ |               |       |

RECEIVED  
 REGISTERED  
 REGISTER OF DEEDS  
 ST. CLAIR COUNTY  
 1995 AUG -4 AM 10:13  
 Register of Deeds Stamp & File Number

4. Lot No. \_\_\_\_\_, Recorded Plat \_\_\_\_\_  
 5. Private Claims \_\_\_\_\_

	A	B	C	D	E	F	G	H	I	J	K	L	M
2	6	5	4	3	2	1							
3													
4	7	8	9	10	11	12							
5													
6	18	17	16	15	14	13							
7													
8	19	20	21	22	23	24							
9													
10	30	29	28	27	26	25							
11													
12	31	32	33	34	35	36							
13													

I, **Daniel E. Johnson**, on **June 23, 1995**, in a field survey on \_\_\_\_\_ do hereby certify that under requirements of P.A. 74, Michigan P.A. of 1970, the corner points mentioned in lines 1 and 2 above were in conformance with regulations and rules therefore as required in the current manual of survey instructions of the United States Department of the Interior, Bureau of Land Management or by a decree of a Court of Law and/or that the corner points mentioned in lines 3, 4 and 5 above were in conformance with the rules of the Michigan Board of Land Surveyors or by a Decree of a Court of Law; established, re-established, monumented, re-monumented, recovered, found as expressed below:

**NOTE: Not more than 1 corner, may be recorded on this certificate.**

A. Description of original monument and accessories and/or subsequent restoration:

LIBER 007 PAGE 368

STATE PLAIN COORDINATES

N. \_\_\_\_\_

E. \_\_\_\_\_

ELEVATION \_\_\_\_\_

B. Description of corner evidence found and/or method applied in restoring or reestablishing corner:

LIBER 007 PAGE 368

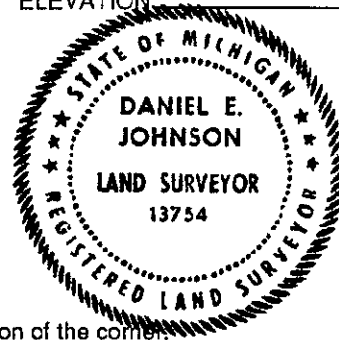

C. Description of monument for corner and accessories established to perpetuate locating the position of the corner:  
 Set with 2" dia. aluminum cap inscribed "St. Clair County Official Corner" with magnet (in Monument Box) on a  
 5/8" iron rod in monument box, 1.5' S of existing centerline of Lapeer Rd. pavement. Located on the true Township line.  
 N 05°E 47.30' to set PK nail w/county remon tag in E side of power pole  
 S 60°E 116.00' to set PK nail w/county remon tag in NE side of power pole  
 S 60°W 165.52' to set PK nail w/county remon tag in NW side of power pole  
 N 60°W 112.59' to set PK nail w/county remon tag in SW side of power pole  
 NORTH 1.5' to centerline of existing Lapeer Road Pavement  
 WEST 2632.67' to S.W. corner Section 34, T7N-R16E  
 EAST 2654.98' to S.E. corner Section 34, T7N-R16E

Signed by \_\_\_\_\_ Date June 23, 1995

Surveyor's Michigan License No. #13754

PA 345-1990  
PEER COMMITTEE

APPROVED AS AN OFFICIAL GOVERNMENT CORNER BY ST. CLAIR COUNTY:

Signed By: Daniel E. Johnson : 7/31/95 Date

St. Clair County Land Surveyor **Daniel E. Johnson**

Surveyor's Michigan License No. #13754

LIBER 008 PAGE 87