

**LAND CORNER RECORDATION CERTIFICATE**  
**Filing Requirement of Act 74, Mich. P.A. 1970**

**LIBER 6 PAGE 25**

STATE OF MICHIGAN  
 ST. JOSEPH COUNTY  
 FILED

29 MAR 2000 10:14:53 AM

CYNTHIA L. JARRATT  
 REGISTER OF DEEDS

For corners in Nottawa Twp.

St. Joseph County Located In: \_\_\_\_\_ Corner Code # \_\_\_\_\_  
 (County)

- |                                    |                      |                                     |
|------------------------------------|----------------------|-------------------------------------|
| 1. Public Land Survey              | T6S R10W             | C-4                                 |
|                                    | T_____ R_____        | _____                               |
|                                    | T_____ R_____        | _____                               |
|                                    | T_____ R_____        | _____                               |
| 2. Property Controlling in Section | S_____ T_____ R_____ | <b>SURVEY &amp; REMONUMENTATION</b> |
|                                    | S_____ T_____ R_____ | _____                               |
| 3. Miscellaneous Property In Sec.  | S_____ T_____ R_____ | <b>JAN 31 2001</b>                  |
|                                    | S_____ T_____ R_____ | _____                               |

Register of Deeds Stamp & File Number

4. Lot No. \_\_\_\_\_, Recorded Plat \_\_\_\_\_ SECTION \_\_\_\_\_  
 5. Private Claims \_\_\_\_\_

I, Wayne A. Mostrom, in a field survey on Feb. 28, 2000 do state that under requirements of P.A. 74, Michigan P.A. of 1970, the corner points mentioned in lines 1 and 2 above were in conformance with regulations and rules therefore as required in the current manual of survey instructions of the United States Department of the Interior, Bureau of Land Management or by a decree of a Court of Law and/or that the corner points mentioned in lines 3, 4 and 5 above were in conformance with the rules of the Michigan Board of Land Surveyors or by a Decree of a Court of Law, established, re-established, monumented, recovered, found as expressed below:

NOTE: Not more than 2 corners, all in the same town and range, may be recorded on this certificate.

1	A	B	C	D	E	F	G	H	I	J	K	L	M
2		6		5		4		3		2		1	
3													
4		7	⊙	8		9		10		11		12	
5													
6		18		17		16		15		14		13	
7													
8		19		20		21		22		23		24	
9													
10		30		29		28		27		26		25	
11													
12		31		32		33		34		35		36	
13													

A. Description of original monument and accessories and/or subsequent restoration:

- |   |   |   |   |
|---|---|---|---|
| <u>1875 Todd Survey in A/470</u><br>3" Ash=N85°W .31 (20.46')<br>12" Hick.=S42°E .57 (37.62') | <u>Road Commission-1964</u><br>1/2" Pipe over large Sto.<br>In Mon. Box<br>31" Ash=N70°E 15.70<br>7" Hick. = S32°E 47.0'<br>17" Ash= S86°E 51.38'<br>35" Ash= 98.35' West | <u>Mostrom 1984 Survey</u><br>3/4" Pipe in Mon. Box<br>17" Ash= S86°E 51.38'<br>35" Ash= West 98.35'<br>in fence line to W. | <u>1991 LCRC in 3/198</u><br>Same Refs. as on<br>1984 & 1991 Survey plus:<br>Cor. is in CL Rdwy |
| <u>1911 Survey in B/456</u><br>Stone<br>Old Cor. Est. by Todd<br>(Same witt. as above)        |   | <u>Mostrom 1991 Survey</u><br>Same as above plus:<br>Gate Post= N60°W 42.15   |   |

B. Description of corner evidence found and/or method applied in restoring or reestablishing corner:

Fd. 3/4" X 48" pipe in Mon. Box in 6' of fill  
 Dug 4 1/2' deep without hitting anything  
 36" Ash= S86°E 51.38'  
 40" Stump= West 98.35'  
 Gate Post= N60°W 42.15'  
 CL New Asphalt is 1.0' West  
 Corner is in fence projection from the East

RATIFIED BY PEER GROUP  
 IN ACCORDANCE WITH P.A. 345  
 ON March 13th, 2000  
Wayne CO. REPRESENTATIVE

C. Description of monument for corner and accessories established to perpetuate locating the position of the corner:

Replaced pipe with 5/8" x 24" bar w/std. cap in Mon. box  
 N & W in S. side 36" Ash = S86°E 51.38'  
 N & W in top 6" fen. post = N60°W 42.15'  
 N & W in SE side P.P. = S78°W 102.33'  
 N & W in E. side fen. post = S14°W 146.10'

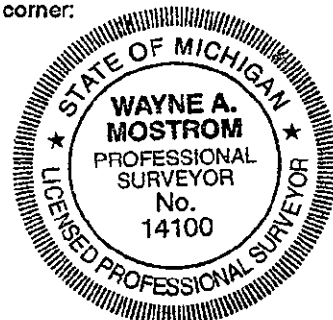

Signed by Wayne A. Mostrom  
 Surveyor's Michigan License No. 14100

Date March 14, 2000

**REMONUMENTATION**

LIBER 6 PAGE 25

25