

LAND CORNER RECORDATION CERTIFICATE
Filing Requirement of Act 74, Mich. P.A. 1970

For corners in
 St. Joseph
 County

Located In: Corner Code //

- | | | |
|------------------------------------|----------------|----|
| 1. Public Land Survey | T 75 R 12W | D2 |
| | T R | |
| | T R | |
| | T R | |
| 2. Property Controlling in Section | S 5 T 75 R 12W | 14 |
| | S T R | |
| 3. Miscellaneous Property in Sec. | S T R | |
| | S T R | |

Register of Deeds Stamp & File Number

4. Lot No. _____, Recorded Plat _____
 5. Private Claims _____

I, Gary C. Bilow, in a field survey on April 13, 1992, 19____, do hereby certify that under requirements of P.A. 74, Michigan P.A. of 1970, the corner points mentioned in lines 1 and 2 above were in conformance with regulations and rules therefore as required in the current manual of survey instructions of the United States Department of the Interior, Bureau of Land Management or by a decree of a Court of Law and/or that the corner points mentioned in lines 3, 4 and 5 above were in conformance with the rules of the Michigan Board of Land Surveyors or by a Decree of a Court of Law; established, re-established, monumented, re-monumented, recovered, found as expressed below.

NOTE: Not more than 4 corners, all in the same town and range, may be recorded on this certificate.

A. Description of original monument and accessories and/or subsequent restoration:

D2: Found no record of corner ever being established.

14: County Surveyor Todd in 1888 records in County Surveyor Records on pages 562 to 564 "set White Oak post (3 x 60) 20 chains south of 1/4 corner and 20 chains north of section corner.

B. Description of corner evidence found and/or method applied in restoring or reestablishing corner:

D2: Established corner at the intersection of N-S 1/4 line and E-W 1/4 line.

14: Found no evidence of corner - reestablished corner midway on line between corners E2 and E3.

C. Description of monument for corner and accessories established to perpetuate locating the position of the corner:

D2: Set 1/2" x 36" rebar encased in 4" diameter concrete cylinder & capped with a cast aluminum Michigan Department of Natural Resources Tablet
 S3W 8.82', N&T west face 24" Oak
 N53W 9.72', N&T south face 12" Oak
 N8W 19.94', N&T west face 18" Cherry
 N53E 20.07', N&T west face 28" Oak

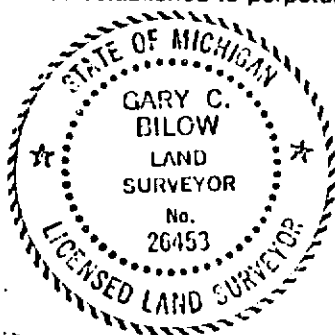

14: Set 1/2" x 36" rebar encased in 4" diameter concrete cylinder & capped with cast aluminum Michigan Department of Natural Resources Tablet
 S4E 13.48', N&T North face 8" Poplar
 S44E 19.14', N&T East face 4" Poplar
 N8W 10.28', N&T West face 12" Cherry
 N69W 23.29', N&T West face 6" Poplar

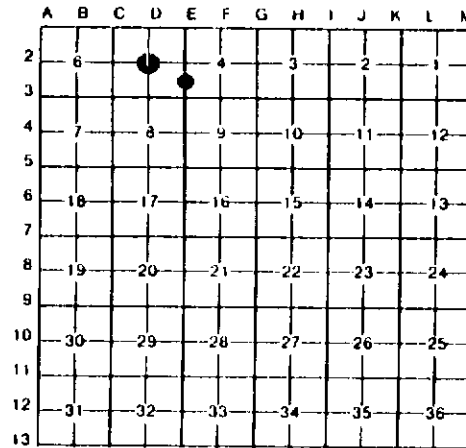

Signed by _____

Date _____