

**SURVEY & REMONUMENTATION**

DEC 1 6 1996

COMMISSION

**LAND CORNER RECORDATION CERTIFICATE**  
Filing Requirement of Act 74, Mich. P.A. 1970

LIBER 4 PAGE 251

For corners in

ST. JOSEPH Located In: \_\_\_\_\_ Corner Code # \_\_\_\_\_  
(County)  
MOTTVILLE TWP.

1. Public Land Survey T 8S R 12W \_\_\_\_\_ C-3  
T \_\_\_\_\_ R \_\_\_\_\_  
T \_\_\_\_\_ R \_\_\_\_\_  
T \_\_\_\_\_ R \_\_\_\_\_

2. Property Controlling S \_\_\_\_\_ T \_\_\_\_\_ R \_\_\_\_\_  
in Section S \_\_\_\_\_ T \_\_\_\_\_ R \_\_\_\_\_

3. Miscellaneous S \_\_\_\_\_ T \_\_\_\_\_ R \_\_\_\_\_  
Property in Sec. S \_\_\_\_\_ T \_\_\_\_\_ R \_\_\_\_\_

STATE OF MICHIGAN  
ST. JOSEPH COUNTY  
FILED

12 SEP 96 8:54 A.M.

CYNTHIA JARRATT  
REGISTER OF DEEDS

Register of Deeds Stamp & File Number

4. Lot No. \_\_\_\_\_, Recorded Plat \_\_\_\_\_  
5. Private Claims \_\_\_\_\_

I, WAYNE A. MOSTROM, in a field survey on SEPT. 9, 1996 do hereby state that under requirements of P.A. 74, Michigan P.A. of 1970, the corner points mentioned in lines 1 and 2 above were in conformance with regulations and rules therefore as required in the current manual of survey instructions of the United States Department of the Interior, Bureau of Land Management or by a decree of a Court of Law and for that the corner points mentioned in lines 3, 4 and 5 above were in conformance with the rules of the Michigan Board of Land Surveyors or by a Decree of a Court of Law; established, re-established, monumented, recovered, found as expressed below:

A	B	C	D	E	F	G	H	I	J	K	L	M
1												
2	6		5		4		3		2		1	
3		7		8		9		10		11		12
4												
5												
6	19		17		16		15		14		13	
7												
8		19		20		21		22		23		24
9												
10	30		29		28		27		26		25	
11												
12		31		32		33		34		35		36
13												

NOTE: Not more than 2 corners, all in the same town and range, may be recorded on this certificate.

A. Description of original monument and accessories and/or subsequent restoration:

ROAD COMM - 1960'S	SAYERS LCRC IN 3/163 (NO DATE)	1983 LCRC BY ENZ IN S/170
STONE UNDER MON. BOX	BOX OVER NOTCHED STONE	BOX OVER STONE 3' W'LY OF CL
12" PINE = S89°W 29.1'	FIR TREE = W'LY 28.9'	MANN ROAD
30" BOX ELDER = S47°W 51.0'	FIR TREE = S'LY (NO DIST. SHOWN)	18" PINE = N85°W 29.10'
FENCE = EAST 23.4'	10" FENCE POST = E'LY 24.32'	21" PINE = N15°W 84.69'
		9" MAPLE = S40°W 45.65'
PIERCE LCRC IN 1973		NE COR. WOOD BLDG. = S80°W 119.87'
STONE IN BOX FENCE = EAST 23.4', 12" PINE = S89°W 29.1', 30" BOX ELDER = S47°W 51.0'		

B. Description of corner evidence found and/or method applied in restoring or reestablishing corner:

FOUND MON. BOX OVER STONE  
PINE = N85°W 29.10'  
PINE = S15°W 84.69'  
MAPLE = S40°W 45.65'  
COR. WOOD BLDG. = S80°W 119.87'  
FIR TREE = W'LY 28.9'

RATIFIED BY PEER GROUP  
IN ACCORDANCE WITH P.A. 345  
ON SEPT. 9, 1996  
Wayne CO. REPRESENTATIVE

CONFLICTING IRON FOUND IS 1.8' N. & 1.8' E. OF STONE & 14" DEEP

C. Description of monument for corner and accessories established to perpetuate locating the position of the corner:

SET 5/8' X 6" BAR W/STD. COUNTY CAP OVER STONE IN MON. BOX  
IRON BAR = 1.8' EAST & 1.8' NORTH  
NE COR. GARAGE = S75°W 119.80'  
N & W IN N. SIDE 24" PINE = WEST 29.10'  
N & W IN E. SIDE 30" PINE = S12°W 84.69'  
N & W IN SE. SIDE 20" POPLAR = S42°W 45.65'  
FENCE PROJ. FROM WEST = NORTH 3.8', CL GRAVEL RDWY = EAST 4'

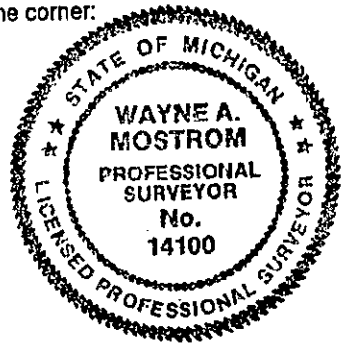

Signed by Wayne A. Mostrom  
Surveyor's Michigan License No. 14100

Date SEPT. 10, 1996

**REMONUMENTATION**

LIBER 4 PAGE 251