

**LAND CORNER RECORDATION CERTIFICATE**  
**Filing Requirement of Act 74, Mich. P.A. 1970**

For corners in  
Schoolcraft

(County)

Located In:

Corner Code #

1. Public Land Survey

T 41N R 13W F4  
 T \_\_\_\_\_ R \_\_\_\_\_  
 T \_\_\_\_\_ R \_\_\_\_\_

2. Property Controlling  
 in Section

S 9 T 41N R 13W 5

3. Miscellaneous  
 Property in Sec.

S \_\_\_\_\_ T \_\_\_\_\_ R \_\_\_\_\_  
 S \_\_\_\_\_ T \_\_\_\_\_ R \_\_\_\_\_

Register of Deeds Stamp & File Number

4. Lot No. \_\_\_\_\_, Recorded Plat \_\_\_\_\_

5. Private Claims \_\_\_\_\_

Jun 23 2004

I, Stephan J. Szyszkoski, in a field survey on \_\_\_\_\_, 19\_\_\_\_ do hereby state that under requirements of P.A. 74, Michigan P.A. of 1970, the corner points mentioned in lines 1 and 2 above were in conformance with regulations and rules therefore as required in the current manual of survey instructions of the United States Department of the Interior, Bureau of Land Management or by a decree of a Court of Law and /or that the corner points mentioned in lines 3, 4 and 5 above were in conformance with the rules of the Michigan Board of Land Surveyors or by a Decree of a Court of Law; established, re-established, monumented, recovered, found as expressed below:

NOTE: Not more than 2 corners, all in the same town and range, may be recorded on this certificate.

A	B	C	D	E	F	G	H	I	J	K	L	M
1												
2	6		5		4		3		2		1	
3												
4	7		8		●		10		11		12	
5												
6	10		17		16		15		14		13	
7												
8	19		20		21		22		23		24	
9												
10	30		29		28		27		26		25	
11												
12	31		32		33		34		35		36	
13												

A. Description of original monument and accessories and/or subsequent restoration:  
 (F4) Center of Section 9. Not established in the original survey.  
 (5-Sec. 9) North 1/16 corner, Sec. 9. Not established in the original survey.

B. Description of corner evidence found and/or method applied in restoring or reestablishing corner:

(F4) Established the corner at the intersection of straight lines connecting opposite 1/4 corners. From the position thus established, the center of the N-S gravel County Road 431 is 8 feet west.  
 (5-Sec. 9) Established the corner midway and on a straight line between Center of Section 1324.70' south and Quarter corner 1324.70' north. From the position thus established, the center of the N-S County Road 431 is 2.5' east. An old fence line, running E'ly, is 9' south.

C. Description of monument for corner and accessories established to perpetuate locating the position of the corner:

(F4) Set 1"IDx36" I.pipe with plastic cap buried in the road. Blazed, scribed, and set meas. nails in: 12" W.Birch N66E 32.05' CS 8T" 4" Cedar N75W 39.8' do 6" Balsam S74W 49.35' do 12" Spruce S78E 25.75' do Bearings are magnetic. Distances are to nail with tag.	(5) Set 1"IDx36" I.pipe with plastic cap, buried in the road. Blazed, scribed, and set measuring nails in: 28" W.Pine S69E 46.2' N1/16 8T" 8" W.Pine S35E 54.7' do Set nails/tags in: 20" W.Pine N50W 56.8' no marks wooden corner fence post (fence north and east) S77E 36.95' Bearings are magnetic. Distances are to nail with tag.
---	---

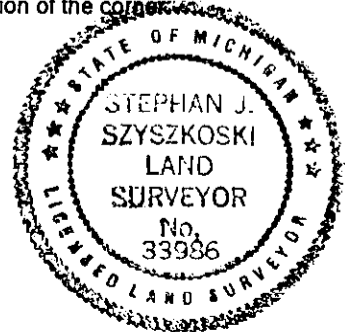

Signed by Stephan J. Szyszkoski  
 Surveyor's Michigan License No. 33986

Date 8/12/04