

**SCHOOLCRAFT COUNTY
PEER GROUP APPROVED**

JAN 23 2000

DATE 12/15/1999 **LAND CORNER RECORDATION CERTIFICATE**
Filing Requirement of Act 74, Mich. P.A. 1970

SECTION _____

For corners in

Schoolcraft (County)	Located In:	Corner Code #
1. Public Land Survey	T <u>41N</u> R <u>14W</u>	<u>E3</u>
	T _____ R _____	_____
	T _____ R _____	_____
	T _____ R _____	_____
2. Property Controlling in Section	S _____ T _____ R _____	_____
	S _____ T _____ R _____	_____
3. Miscellaneous Property in Sec.	S _____ T _____ R _____	_____
	S _____ T _____ R _____	_____

SIGRID HEDBERG 1P
SCHOOLCRAFT CO. REGISTER
Page 1 of 1 LC 4/331
JLV Date 12/30/1999 Time 13:58:01
RECORDING FEES: 9.00

Register of Deeds Stamp & File Number

4. Lot No. _____, Recorded Plat _____
5. Private Claims _____

	A	B	C	D	E	F	G	H	I	J	K	L	M
1													
2	6			5		4		3		2		1	
3					*								
4	7			8		9		10		11		12	
5													
6	18			17		16		15		14		13	
7													
8	19			20		21		22		23		24	
9													
10	30			29		28		27		26		25	
11													
12	31			32		33		34		35		36	
13													

I, Thomas P. O'Brien in a field survey on Dec. 21, 1999 do hereby state that under requirements of P.A. 74, Michigan P.A. of 1970, the corner points mentioned in lines 1 and 2 above were in conformance with regulations and rules therefore as required in the current manual of survey instructions of the United States Department of the Interior, Bureau of Land Management or by a decree of a Court of Law and/or that the corner points mentioned in lines 3, 4 and 5 above were in conformance with the rules of the Michigan Board of Land Surveyors or by a Decree of a Court of Law; established, re-established, monumented, recovered, found as expressed below:

NOTE: Not more than 2 corners, all in the same town and range, may be recorded on this certificate.

A. Description of original monument and accessories and/or subsequent restoration:

Sept. 6, 1845 J. Burt, DS set post corner of Section 4, 5, 8 & 9
W. Pine 14 N55E 21 Shae 4 S78W 38

Oct. 15, 1987 William F. Bowman, PS reset corner from 14" W. Pine stump N55E 13.9'.
Set iron bar w/28406 cap.

B. Description of corner evidence found and/or method applied in restoring or reestablishing corner:

Dec. 21, 1999 Thomas P. O'Brien, PS found iron bar w/28406 at record survey distance from Michibay Drive. Stump remains N55E 13.9' present. Reset iron bar with Schoolcraft County monument stamped to identify.

C. Description of monument for corner and accessories established to perpetuate locating the position of the corner:

Schoolcraft County monument
Witnesses:
14" Red Pine S8°W 9.9'
12" Red Pine N64°W 39.8'
10" White Pine N62°E 26.6'
6" White Pine N26°E 19.05'
Carsonite Post North 1.0'

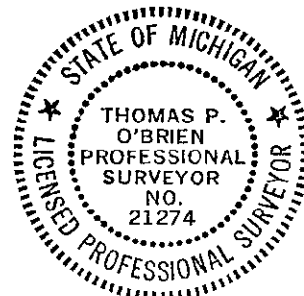

Signed by Thomas P. O'Brien
Surveyor's Michigan License No. 21274

Date Dec. 22, 1999