

**SCHOOLCRAFT COUNTY
PEER GROUP APPROVED**

JAN 25 2000

SECTION

DATE 12/15/99 JOP **LAND CORNER RECORDATION CERTIFICATE**
Filing Requirement of Act 74, Mich. P.A. 1970

For corners in Schoolcraft (County)	Located In:	Corner Code #
1. Public Land Survey	T 41NR 14W	L5
	T R	
	T R	
	T R	
2. Property Controlling in Section	S T R	
	S T R	
3. Miscellaneous Property in Sec.	S T R	
	S T R	

SIGRID HEDBERG
SCHOOLCRAFT CO. REGISTER
Page 1 of 1
JLO Date 12/30/1999 Time 13:55:03
RECORDING FEES: 9.00

Register of Deeds Stamp & File Number

4. Lot No. _____, Recorded Plat _____
5. Private Claims _____

I, Thomas P. O'Brien, in a field survey on 12/29, 1999 do hereby state that under requirements of P.A. 74, Michigan P.A. of 1970, the corner points mentioned in lines 1 and 2 above were in conformance with regulations and rules therefore as required in the current manual of survey instructions of the United States Department of the Interior, Bureau of Land Management or by a decree of a Court of Law and /or that the corner points mentioned in lines 3, 4 and 5 above were in conformance with the rules of the Michigan Board of Land Surveyors or by a Decree of a Court of Law; established, re-established, monumented, recovered, found as expressed below:

	A	B	C	D	E	F	G	H	I	J	K	L	M
1													
2	6	5	4	3	2	1							
3													
4	7	8	9	10	11	12							
5													
6	18	17	16	15	14	13							
7													
8	19	20	21	22	23	24							
9													
10	30	29	28	27	26	25							
11													
12	31	32	33	34	35	36							
13													

NOTE: Not more than 2 corners, all in the same town and range, may be recorded on this certificate.

A. Description of original monument and accessories and/or subsequent restoration:
Sept. 5, 1845 J. Burt DS set qr. section post B.Oak 4 N76E 25 W Pine 5 S61W 78

B. Description of corner evidence found and/or method applied in restoring or reestablishing corner:
Dec. 29, 1999 Thomas P. O'Brien, PS reestablished corner at GLO distance and parallel with the North line of Section 12. Set Schoolcraft County monument stamped to identify.

C. Description of monument for corner and accessories established to perpetuate locating the position of the corner:

- Schoolcraft County monument
Witnesses:
12" Red Pine N19°W 59.47'
10" Red Pine S64°W 29.32'
10" Maple S8°W 39.87'
12" Red Pine S63°E 50.70'
Carsonite Post North 1.0'

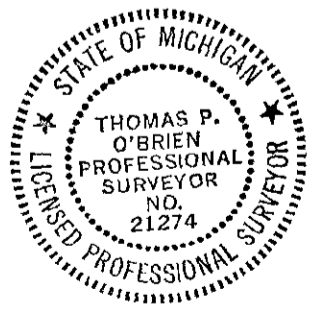

Thomas P. O'Brien

Signed by Thomas P. O'Brien
Surveyor's Michigan License No. 21274

Date Dec. 30, 1999