

JAN 25 2000

SCHOOLCRAFT COUNTY PEER GROUP APPROVED

SECTION

DATE 12/15/1999 **LAND CORNER RECORDATION CERTIFICATE**
Filing Requirement of Act 74, Mich. P.A. 1970

For corners in

Schoolcraft (County)	Located In:	Corner Code #
1. Public Land Survey	T 41N R 14W	M1 ✓
	T 41N R 13W	A1
	T 42N R 14W	M13
	T 42N R 13W	A13
2. Property Controlling in Section	S _____ T _____ R _____	_____
	S _____ T _____ R _____	_____
3. Miscellaneous Property in Sec.	S _____ T _____ R _____	_____
	S _____ T _____ R _____	_____

SIGRID HEDBERG 1P
SCHOOLCRAFT CO. REGISTER
Page 1 of 1 LC 4/330
JLO Date 12/30/1999 Time 13:57:51
RECORDING FEES: 9.00

Register of Deeds Stamp & File Number

4. Lot No. _____, Recorded Plat _____
5. Private Claims _____

I, Thomas P. O'Brien, in a field survey on 12/21, 1999 do hereby state that under requirements of P.A. 74, Michigan P.A. of 1970, the corner points mentioned in lines 1 and 2 above were in conformance with regulations and rules therefore as required in the current manual of survey instructions of the United States Department of the Interior, Bureau of Land Management or by a decree of a Court of Law and/or that the corner points mentioned in lines 3, 4 and 5 above were in conformance with the rules of the Michigan Board of Land Surveyors or by a Decree of a Court of Law; established, re-established, monumented, recovered, found as expressed below:

NOTE: Not more than 2 corners, all in the same town and range, may be recorded on this certificate.

	A	B	C	D	E	F	G	H	I	J	K	L	M
1													
2	6		5		4		3		2		1		
3													
4	7		8		9		10		11		12		
5													
6	18		17		16		15		14		13		
7													
8	19		20		21		22		23		24		
9													
10	30		29		28		27		26		25		
11													
12	31		32		33		34		35		36		
13													

A. Description of original monument and accessories and/or subsequent restoration:

1845 John Burt DS Post corner Towns 41 & 42 N Ranges 13 & 14 W
Cedar 7 N45E 30 Fir S18W 26

August 10, 1967 Billy D. Buckler, RLS "corner replaced as set by Carl Christiansen, Manistique. Found a 3/4" x 24" iron pin buried in center of E&W road, with old brushed line bearing North from this corner."

B. Description of corner evidence found and/or method applied in restoring or reestablishing corner:

Dec. 21, 1999 Thomas P. O'Brien, PS recovered iron rod verified by Buckler witnesses. Reset iron rod with Schoolcraft County monument stamped to identify set 6" below gravel surface in centerline of E&W road. Fence line South-open brush line North.

C. Description of monument for corner and accessories established to perpetuate locating the position of the corner:

Schoolcraft County monument
Witnesses;
8" Cedar S30°E 27.7'
8" Cedar S6°W 20.6'
6" Cedar N9°W 36.1'
8" Cedar N39°E 34.80'
Carsonite Post North 20.0'

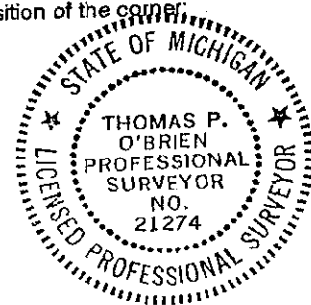

Signed by Thomas P. O'Brien
Surveyor's Michigan License No. 21274

Date Dec. 22, 1999