

JAN 21 1999

SCHOOLCRAFT COUNTY
PEER GROUP APPROVED

DATE 12/2/98 JAS LAND CORNER RECORDATION CERTIFICATE
Filing Requirement of Act 74, Mich. P.A. 1970

SECTION

For corners in

Schoolcraft
(County)

Located In:

Corner Code #

SIGRID HEDBERG 1P
SCHOOLCRAFT CO. REGISTER
Page 1 of 1 LC 4/244
JLO Rec. Date 12/15/98 Time 14:23
REVENUE FEES: 9.00

1. Public Land Survey

T41N R16W

M5
A5

T41N R15W

T R

T R

2. Property Controlling in Section

S T R

S T R

3. Miscellaneous Property in Sec.

S T R

S T R

SURVEY &
REMONUMENTATION

MAR 03 1999

Register of Deeds Stamp & File Number

4. Lot No. _____, Recorded Plat _____ SECTION _____
5. Private Claims _____

	A	B	C	D	E	F	G	H	I	J	K	L	M
1													
2	6		5		4		3		2		1		
3													
4	7		8		9		10		11		12		
5													
6	18		17		16		15		14		13		
7													
8	19		20		21		22		23		24		
9													
10	30		29		28		27		26		25		
11													
12	31		32		33		34		35		36		
13													

I, Thomas P. O'Brien in a field survey on Dec. 4, 1998 do hereby state that under requirements of P.A. 74, Michigan P.A. of 1970, the corner points mentioned in lines 1 and 2 above were in conformance with regulations and rules therefore as required in the current manual of survey instructions of the United States Department of the Interior, Bureau of Land Management or by a decree of a Court of Law and/or that the corner points mentioned in lines 3, 4 and 5 above were in conformance with the rules of the Michigan Board of Land Surveyors or by a Decree of a Court of Law, established, re-established, monumented, recovered, found as expressed below:

NOTE: Not more than 2 corners, all in the same town and range, may be recorded on this certificate.

A. Description of original monument and accessories and/or subsequent restoration:

M5 NE Corner Section 13, T41N - R16W
1845 - John Burt D.S set post corner of sections 12 & 13 T41N - R16W and sections 7 & 18 T41N - R15W, referenced by: W.Pine 22 N51W 32 W. Birch 18 S27W 37
Nov. 7, 1985 - William F. Bowman L.S. #28406 recovered a 3/4" bar, as noted in Liber 1 of surveys Pg. 320 - 321.

B. Description of corner evidence found and/or method applied in restoring or reestablishing corner:

M5 Dec. 4, 1998 - Thomas P. O'Brien P.S. recovered 3/4" iron rod in monument box .40' below black top in centerline of Range street and Manistique avenue to the East. Witnesses found verify corner location as found by Bowman RLS 28406 on Nov. 7, 1985. Raised iron rod with iron bar and O'Brien 21274 cap and reset monument box.

C. Description of monument for corner and accessories established to perpetuate locating the position of the corner:

M5 Iron Bar with O'Brien 21274 cap in Monument Box. Made measurements to the following references:

- (Fd.) T. Pole - N29°E - 51.15'
- (Fd.) T. Pole - S31°E - 41.75'
- NBT 24" Maple - S24°W - 64.68'
- S.E. corner of house foundation - N47°W - 73.20'

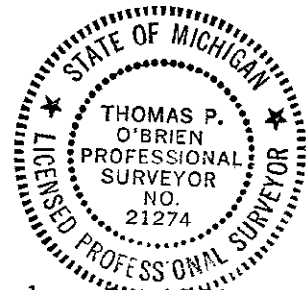

Thomas P. O'Brien

Signed by Thomas P. O'Brien

Date December 6, 1998

Surveyor's Michigan License No. 21274