

**SCHOOLCRAFT COUNTY
PEER GROUP APPROVED**

DATE 10/21/98 JOB

**LAND CORNER RECORDATION CERTIFICATE
Filing Requirement of Act 74, Mich. P.A. 1970**

**SURVEY &
REMONUMENTATION**

JAN 21 1999

SECTION

For corners in

Schoolcraft Located In: Corner Code #
(County)

1. Public Land Survey T41NR16W A-13
T41NR17W M-13 ✓
T R
T R
2. Property Controlling S T R
in Section S T R
3. Miscellaneous S T R
Property in Sec. S T R

SIGRID HEDBERG
SCHOOLCRAFT CO. REGISTER 1P
Page 1 of 1
JLO Rec. Date 12/03/98 LC 4/217
REVENUE FEES: Time 14:29
9.00

Register of Deeds Stamp & File Number

4. Lot No. _____, Recorded Plat _____
5. Private Claims _____

I, Thomas P. O'Brien in a field survey on Nov. 5, 1998 do hereby state that under requirements of P.A. 74, Michigan P.A. of 1970, the corner points mentioned in lines 1 and 2 above were in conformance with regulations and rules therefore as required in the current manual of survey instructions of the United States Department of the Interior, Bureau of Land Management or by a decree of a Court of Law and/or that the corner points mentioned in lines 3, 4 and 5 above were in conformance with the rules of the Michigan Board of Land Surveyors or by a Decree of a Court of Law; established, re-established, monumented, recovered, found as expressed below:

1	A	B	C	D	E	F	G	H	I	J	K	L	M
2	6		5		4		3		2		1		
3													
4	7		8		9		10		11		12		
5													
6	18		17		16		15		14		13		
7													
8	19		20		21		22		23		24		
9													
10	30		29		28		27		26		25		
11													
12	31		32		33		34		35		36		
13													

NOTE: Not more than 2 corners, all in the same town and range, may be recorded on this certificate.

A. Description of original monument and accessories and/or subsequent restoration:

A13 SW Corner Section 31, T41N - R16W
1845 - John Burt D.S. set post corner of Towns 41 North and Ranges 16 & 17 West referenced by: Tamarack 10 N69½W 15 Tamarack 12 N33½E 58

Dec. 1982 - L.C.R.C. by Thomas P. O'Brien (L.1, Pg. 296, P.S. 21274) indicates that corner was set by "Single Proportionate Measurement between the South ½ corner, Section 32, T41N-R17W and the section corner common to Sections 31 and 32, T41N-R16W."

B. Description of corner evidence found and/or method applied in restoring or reestablishing corner:

A13 Nov. 5, 1998 - Thomas P. O'Brien P.S. recovered a Schoolcraft County Monument stamped to identify. Witnesses found check well with O'Brien L.C.R.C. (L.1 Pg. 296 P.S. 21274).

C. Description of monument for corner and accessories established to perpetuate locating the position of the corner:

A13 Schoolcraft County Monument stamped to identify. Repainted blazes on NBT's and made measurements to the following references:

- (Fd.) 8" Cedar - N7°W - 8.95'
- (Fd.) 8" Cedar - N75°E - 22.35'
- (Fd.) 8" Cedar - S33°W - 23.75'
- NBT 6" Cedar - S25°E - 11.57'
- Carsonite post - North - 1.0'

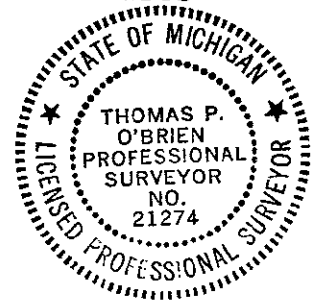

Thomas P. O'Brien

Signed by Thomas P. O'Brien
Surveyor's Michigan License No. 21274

Date November 27, 1998