

SCHOOLCRAFT COUNTY PEER GROUP APPROVED

RECORDED BY _____

JAN 25 2000

DATE 11/8/99 OOB LAND CORNER RECORDATION CERTIFICATE
Filing Requirement of Act 74, Mich. P.A. 1970

For corners in

SECTION _____

Schoolcraft (County)	Located In:	Corner Code #
1. Public Land Survey	T <u>41N</u> R <u>15W</u>	<u>E3</u>
	T _____ R _____	_____
	T _____ R _____	_____
	T _____ R _____	_____
2. Property Controlling in Section	S _____ T _____ R _____	_____
	S _____ T _____ R _____	_____
3. Miscellaneous Property in Sec.	S _____ T _____ R _____	_____
	S _____ T _____ R _____	_____

SIGRID HEDBERG 1P
SCHOOLCRAFT CO. REGISTER
Page 1 of 1 LC 4/302
JLQ Date 12/22/1999 Time 13:53:38
RECORDING FEES: 9.00

Register of Deeds Stamp & File Number

4. Lot No. _____, Recorded Plat _____
5. Private Claims _____

I, Thomas P. O'Brien in a field survey on Nov. 23, 19 99 do hereby state that under requirements of P.A. 74, Michigan P.A. of 1970, the corner points mentioned in lines 1 and 2 above were in conformance with regulations and rules therefore as required in the current manual of survey instructions of the United States Department of the Interior, Bureau of Land Management or by a decree of a Court of Law and/or that the corner points mentioned in lines 3, 4 and 5 above were in conformance with the rules of the Michigan Board of Land Surveyors or by a Decree of a Court of Law; established, re-established, monumented, recovered, found as expressed below:

NOTE: Not more than 2 corners, all in the same town and range, may be recorded on this certificate.

	A	B	C	D	E	F	G	H	I	J	K	L	M
1													
2	6			5			4		3		2		1
3					*								
4	7			8			9		10		11		12
5													
6	18			17			16		15		14		13
7													
8	19			20			21		22		23		24
9													
10	30			29			28		27		26		25
11													
12	31			32			33		34		35		36
13													

A. Description of original monument and accessories and/or subsequent restoration:
Sept. 8, 1845 J. Burt, DS set post corner of Sections 4, 5, 8, 9 Hemlock 24 N63E 59 Beech 8 S28W 21
March 8, 1977 Thomas P. O'Brien, PS noted on LCRC that corner was referred to in Plat of Lakeview Bluff.
May 11, 1978 Douglas W. Hooth, RLS found 3" square concrete monument w/1/2" iron pipe buried 1.5' from 1929 MSH R/W print distance and stationing. Also a Polaris Assc. Inc. reference tab RLS 14200.

B. Description of corner evidence found and/or method applied in restoring or reestablishing corner:
Nov. 23, 1999 Thomas P. O'Brien, PS found copper clad rod over top of 3" sq. concrete monument. Replaced w/Schoolcraft County monument stamped to identify.

C. Description of monument for corner and accessories established to perpetuate locating the position of the corner:

Schoolcraft County monument
Witnesses:
20" Spruce N55°W 85.17'
Power Pole S70°W 67.37'
Power Pole S79°E 45.73'
16" Spruce N26°E 51.95'
Carsonite Post East 15.0'

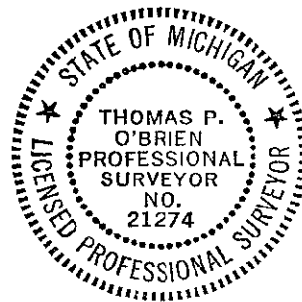

Signed by Thomas P. O'Brien
Surveyor's Michigan License No. 21274

Date 12/16/99