

**SCHOOLCRAFT COUNTY  
PEER GROUP APPROVED**

**SURVEY &  
REMONUMENTATION**

DATE 10/10/00 008 LAND CORNER RECORDATION CERTIFICATE  
Filing Requirement of Act 74, Mich. P.A. 1970

FEB 08 2001

For corners in

Schoolcraft  
(County)

Located In:

Corner Code #

SECTION

1. Public Land Survey

T 42N R 13W A10

SIGRID HEDBERG 1P  
SCHOOLCRAFT CO. REGISTER  
Page 1 of 1 LC 4/413  
JLV Date 12/28/2000 Time 11:28:09

2. Property Controlling  
in Section

S \_\_\_\_\_ T \_\_\_\_\_ R \_\_\_\_\_

3. Miscellaneous  
Property in Sec.

S \_\_\_\_\_ T \_\_\_\_\_ R \_\_\_\_\_

4. Lot No. \_\_\_\_\_, Recorded Plat \_\_\_\_\_

5. Private Claims \_\_\_\_\_

Register of Deeds Stamp & File Number

I, Thomas P. O'Brien, in a field survey on 10/31/00 ~~xxx~~ do hereby state that under requirements of P.A. 74, Michigan P.A. of 1970, the corner points mentioned in lines 1 and 2 above were in conformance with regulations and rules therefore as required in the current manual of survey instructions of the United States Department of the Interior, Bureau of Land Management or by a decree of a Court of Law and/or that the corner points mentioned in lines 3, 4 and 5 above were in conformance with the rules of the Michigan Board of Land Surveyors or by a Decree of a Court of Law; established, re-established, monumented, recovered, found as expressed below:

NOTE: Not more than 2 corners, all in the same town and range, may be recorded on this certificate.

|    | A  | B | C | D  | E | F | G  | H | I  | J | K  | L | M  |
|----|----|---|---|----|---|---|----|---|----|---|----|---|----|
| 1  |    |   |   |    |   |   |    |   |    |   |    |   |    |
| 2  | 6  |   |   | 5  |   |   | 4  |   | 3  |   | 2  |   | 1  |
| 3  |    |   |   |    |   |   |    |   |    |   |    |   |    |
| 4  | 7  |   |   | 8  |   |   | 9  |   | 10 |   | 11 |   | 12 |
| 5  |    |   |   |    |   |   |    |   |    |   |    |   |    |
| 6  | 18 |   |   | 17 |   |   | 16 |   | 15 |   | 14 |   | 13 |
| 7  |    |   |   |    |   |   |    |   |    |   |    |   |    |
| 8  | 19 |   |   | 20 |   |   | 21 |   | 22 |   | 23 |   | 24 |
| 9  |    |   |   |    |   |   |    |   |    |   |    |   |    |
| 10 | 30 |   |   | 29 |   |   | 28 |   | 27 |   | 26 |   | 25 |
| 11 |    |   |   |    |   |   |    |   |    |   |    |   |    |
| 12 | 31 |   |   | 32 |   |   | 33 |   | 34 |   | 35 |   | 36 |
| 13 |    |   |   |    |   |   |    |   |    |   |    |   |    |

A. Description of original monument and accessories and/or subsequent restoration:

April 1851 Algernon Merryweather DS destroyed Guy H. Carleton post and witnesses in remeasurement.

Aug. 4, 1975 Thomas P. O'Brien RLS "found angle iron at road intersection South and East. 1979 reset with county monument by County Surveyor.

B. Description of corner evidence found and/or method applied in restoring or reestablishing corner:

Oct. 31, 2000 Thomas P. O'Brien PS found Schoolcraft County monument incorrectly stamped and replaced with properly stamped Schoolcraft County monument.

C. Description of monument for corner and accessories established to perpetuate locating the position of the corner:

Schoolcraft County monument stamped to identify.

Witnesses:

- 16" Maple N38°E 18.57'
- 8" Cedar N55°W 35.89'
- 24" Beech S39°W 38.05'
- 8" Maple S30°E 83.10'
- Carsonite Post North 1.0'

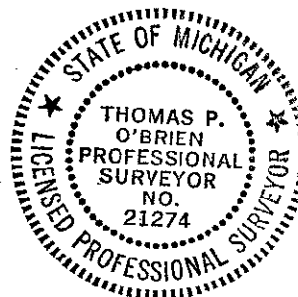

Signed by Thomas P. O'Brien

Date Dec. 27, 2000

Surveyor's Michigan License No. 21274

LIBER 4 PAGE: 43