

SCHOOLCRAFT COUNTY PEER GROUP APPROVED

JAN 5 2000

SECTION

DATE 12/15/99 JOBS

LAND CORNER RECORDATION CERTIFICATE Filing Requirement of Act 74, Mich. P.A. 1970

For corners in

| Schoolcraft (County) | Located in: | Corner Code # |
|---------------------------------------|--|-------------------------------|
| 1. Public Land Survey | T 41N R 14W T 42N R 14W T ___ R ___ T ___ R ___ | D1 D13 ✓ _____ _____ |
| 2. Property Controlling in Section | S ___ T ___ R ___ S ___ T ___ R ___ | _____ _____ |
| 3. Miscellaneous Property in Sec. | S ___ T ___ R ___ S ___ T ___ R ___ | _____ _____ |

SIGRID HEDBERG 1P
SCHOOLCRAFT CO. REGISTER
Page 1 of 1 LC 4/327
JLO Date 12/30/1999 Time 13:57:23
RECORDING FEES: 9.00

Register of Deeds Stamp & File Number

4. Lot No. _____, Recorded Plat _____
5. Private Claims _____

I, Thomas P. O'Brien, in a field survey on 12/23, 1999 do hereby state that under requirements of P.A. 74, Michigan P.A. of 1970, the corner points mentioned in lines 1 and 2 above were in conformance with regulations and rules therefore as required in the current manual of survey instructions of the United States Department of the Interior, Bureau of Land Management or by a decree of a Court of Law and/or that the corner points mentioned in lines 3, 4 and 5 above were in conformance with the rules of the Michigan Board of Land Surveyors or by a Decree of a Court of Law; established, re-established, monumented, recovered, found as expressed below:

NOTE: Not more than 2 corners, all in the same town and range, may be recorded on this certificate.

| | A | B | C | D | E | F | G | H | I | J | K | L | M |
|----|---|----|---|----|---|----|---|----|---|----|---|----|---|
| 1 | | | | | | | | | | | | | |
| 2 | | 6 | | 5 | | 4 | | 3 | | 2 | | 1 | |
| 3 | | | | | | | | | | | | | |
| 4 | | 7 | | 8 | | 9 | | 10 | | 11 | | 12 | |
| 5 | | | | | | | | | | | | | |
| 6 | | 18 | | 17 | | 16 | | 15 | | 14 | | 13 | |
| 7 | | | | | | | | | | | | | |
| 8 | | 19 | | 20 | | 21 | | 22 | | 23 | | 24 | |
| 9 | | | | | | | | | | | | | |
| 10 | | 30 | | 29 | | 28 | | 27 | | 26 | | 25 | |
| 11 | | | | | | | | | | | | | |
| 12 | | 31 | | 32 | | 33 | | 34 | | 35 | | 36 | |
| 13 | | | | | | | | | | | | | |

A. Description of original monument and accessories and/or subsequent restoration:

1851 Algernon Merryweather, DS Remeasurement Beech 20 in N27W 40 Sugar 7 N10E 27

B. Description of corner evidence found and/or method applied in restoring or reestablishing corner:

Dec. 23, 1999 Thomas P. O'Brien, PS reestablished corner in centerline of County Road (Bergman Road) to North, two track road to South and old downed fence line East and West. Set Schoolcraft County monument stamped to identify.

C. Description of monument for corner and accessories established to perpetuate locating the position of the corner:

Schoolcraft County monument
Witnesses:
10" Twin Spruce S76°W 74.53'
Power Pole S20°E 90.05'
10" White Pine N85°E 92.43'
911 Post No. 739N S31°W 73.02'
Carsonite Post West 25.0'

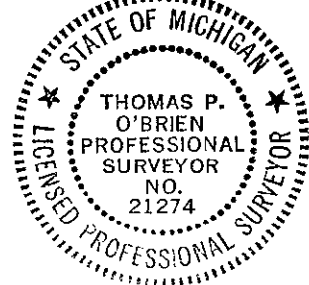

Signed by Thomas P. O'Brien
Surveyor's Michigan License No. 21274

Date Dec. 30, 1999