

SCHOOLCRAFT COUNTY PEER GROUP APPROVED

**SURVEY &
REMONUMENTATION**

FEB 08 2001

DATE 10/10/00 **LAND CORNER RECORDATION CERTIFICATE**
Filing Requirement of Act 74, Mich. P.A. 1970

SECTION

For corners in

Schoolcraft (County)	Located In:	Corner Code #
1. Public Land Survey	T <u>42NR14W</u>	<u>G2</u>
	T ___ R ___	_____
	T ___ R ___	_____
	T ___ R ___	_____
2. Property Controlling in Section	S ___ T ___ R ___	_____
	S ___ T ___ R ___	_____
3. Miscellaneous Property in Sec.	S ___ T ___ R ___	_____
	S ___ T ___ R ___	_____

SIGRID HEDBERG 1P
SCHOOLCRAFT CO. REGISTER
Page 1 of 1 LC 4/364
JLO Date 12/19/2000 Time 11:53:14

Register of Deeds Stamp & File Number

4. Lot No. _____, Recorded Plat _____
5. Private Claims _____

I, Thomas P. O'Brien, in a field survey on 10/30/00 ~~xxx~~ do hereby state that under requirements of P.A. 74, Michigan P.A. of 1970, the corner points mentioned in lines 1 and 2 above were in conformance with regulations and rules therefore as required in the current manual of survey instructions of the United States Department of the Interior, Bureau of Land Management or by a decree of a Court of Law and /or that the corner points mentioned in lines 3, 4 and 5 above were in conformance with the rules of the Michigan Board of Land Surveyors or by a Decree of a Court of Law; established, re-established, monumented, recovered, found as expressed below:

NOTE: Not more than 2 corners, all in the same town and range, may be recorded on this certificate.

	A	B	C	D	E	F	G	H	I	J	K	L	M
1													
2	6		5		4	X	3		2			1	
3													
4	7		8		9		10		11			12	
5													
6	13		17		16		15		14			13	
7													
8	19		20		21		22		23			24	
9													
10	30		29		28		27		26			25	
11													
12	31		32		33		34		35			36	
13													

A. Description of original monument and accessories and/or subsequent restoration:

April 12, 1851 Algernon Merryweather, DS set 1/4 post Sugar 14 in N70W 24 links
Sugar 10 in S78E 38 links
April 1986 William F. Bowman LLS " re-established by proportionate measure by survey between G1 and G3."

B. Description of corner evidence found and/or method applied in restoring or reestablishing corner:

Oct.30, 2000 Thomas P. O'Brien, PS found iron bar with 21274 cap set from Bowman witnesses. Accepted corner position and reset with Schoolcraft County monument.

C. Description of monument for corner and accessories established to perpetuate locating the position of the corner:

Schoolcraft County monument stamped to identify.
Witnesses:
10" Maple S53°E 48.90'
Power Pole S80°W 27.20'
12" Maple N51°W 64.55'
8" Maple S85°E 28.12'
Centerline Co. road East 6.0'
Carsonite Post N85°W 30.0'

Thomas P. O'Brien

Signed by Thomas P. O'Brien
Surveyor's Michigan License No. 21274

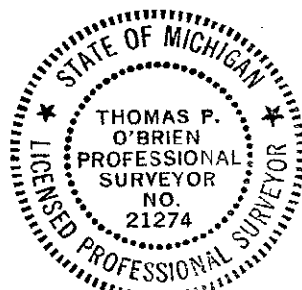

Date Dec.12, 2000