

**SCHOOLCRAFT COUNTY
PEER GROUP APPROVED**

**SURVEY &
REMONUMENTATION**

FEB 08 2001

DATE 10/10/00 POB **LAND CORNER RECORDATION CERTIFICATE**
Filing Requirement of Act 74, Mich. P.A. 1970

SECTION

For corners in

Schoolcraft (County)	Located in:	Corner Code #
1. Public Land Survey	T <u>42N</u> R <u>14W</u>	<u>G10</u>
	T <u> </u> R <u> </u>	<u> </u>
	T <u> </u> R <u> </u>	<u> </u>
	T <u> </u> R <u> </u>	<u> </u>
2. Property Controlling in Section	S <u> </u> T <u> </u> R <u> </u>	<u> </u>
	S <u> </u> T <u> </u> R <u> </u>	<u> </u>
3. Miscellaneous Property in Sec.	S <u> </u> T <u> </u> R <u> </u>	<u> </u>

SIGRID HEDBERG
SCHOOLCRAFT CO. REGISTER 1P
Page 1 of 1 LC 4/384
JLV Date 12/19/2000 Time 11:53:26

Register of Deeds Stamp & File Number

4. Lot No. _____, Recorded Plat _____
5. Private Claims _____

	A	B	C	D	E	F	G	H	I	J	K	L	M
1													
2	6		5		4		3		2		1		
3													
4	7		8		9		10		11		12		
5													
6	18		17		16		15		14		13		
7													
8	19		20		21		22		23		24		
9													
10	30		29		28		27		26		25		
11													
12	31		32		33		34		35		36		
13													

I, Thomas P. O'Brien, in a field survey on 10/25/00, do hereby state that under requirements of P.A. 74, Michigan P.A. of 1970, the corner points mentioned in lines 1 and 2 above were in conformance with regulations and rules therefore as required in the current manual of survey instructions of the United States Department of the Interior, Bureau of Land Management or by a decree of a Court of Law and /or that the corner points mentioned in lines 3, 4 and 5 above were in conformance with the rules of the Michigan Board of Land Surveyors or by a Decree of a Court of Law, established, re-established, monumented, recovered, found as expressed below:

NOTE: Not more than 2 corners, all in the same town and range, may be recorded on this certificate.

A. Description of original monument and accessories and/or subsequent restoration:

April 10, 1851 Algernon Merryweather, DS set $\frac{1}{4}$ post Cedar 9 in N40E 20 links
Sugar 8 in S70W 9 links

B. Description of corner evidence found and/or method applied in restoring or reestablishing corner:

Oct. 25, 2000 Thomas P. O'Brien, PS re-established corner by proportionated N and S measurement and in centerline of existing N and S County Road. Set Schoolcraft County monument.

C. Description of monument for corner and accessories established to perpetuate locating the position of the corner:

Schoolcraft County monument stamped to identify.

- Witnesses:
6" Maple S77°W 17.90'
4" Maple N51°W 30.68'
12" Cedar N58°E 45.88'
8" Cedar S74°E 42.32'
Carsonite Post S85°E 25.0'

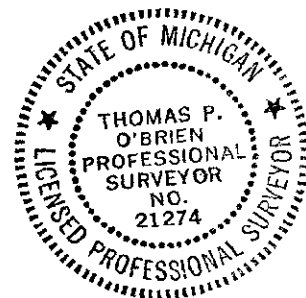

Signed by Thomas P. O'Brien
Surveyor's Michigan License No. 21274

Date Dec. 12, 2000

LIBER 4 PAGE: 384