

**SCHOOLCRAFT COUNTY
PEER GROUP APPROVED**

JAN 3 2000

DATE 12/15/1999

**LAND CORNER RECORDATION CERTIFICATE
Filing Requirement of Act 74, Mich. P.A. 1970**

SECTION _____

For corners in

Schoolcraft (County)	Located In:	Corner Code #
1. Public Land Survey	T41N R14W	G1
	T42N R14W	G13 ✓
	T___ R___	_____
	T___ R___	_____
2. Property Controlling in Section	S___ T___ R___	_____
	S___ T___ R___	_____
3. Miscellaneous Property in Sec.	S___ T___ R___	_____
	S___ T___ R___	_____

SIGRID HEDBERG 1P
SCHOOLCRAFT CO. REGISTER
Page 1 of 1 LC 4/314
JLO Date 12/30/1999 Time 13:53:27
RECORDING FEES: 9.00

Register of Deeds Stamp & File Number

4. Lot No. _____, Recorded Plat _____
5. Private Claims _____

	A	B	C	D	E	F	G	H	I	J	K	L	M
1													
2	6		5		4		3		2		1		
3													
4	7		8		9		10		11		12		
5													
6	18		17		16		15		14		13		
7													
8	19		20		21		22		23		24		
9													
10	30		29		28		27		26		25		
11													
12	31		32		33		34		35		36		
13													

I, thomas P. O'Brien, in a field survey on 12/20, 1999 do hereby state that under requirements of P.A. 74, Michigan P.A. of 1970, the corner points mentioned in lines 1 and 2 above were in conformance with regulations and rules therefore as required in the current manual of survey instructions of the United States Department of the Interior, Bureau of Land Management or by a decree of a Court of Law and /or that the corner points mentioned in lines 3, 4 and 5 above were in conformance with the rules of the Michigan Board of Land Surveyors or by a Decree of a Court of Law; established, re-established, monumented, recovered, found as expressed below:

NOTE: Not more than 2 corners, all in the same town and range, may be recorded on this certificate.

A. Description of original monument and accessories and/or subsequent restoration:

April 1851 Algernon Merryweather, DS Set post corner (Remeasured) Cedar 6in N20W 7
" 7" N75E 11 BT's added after section corners set - Cedar 8 S71E 24 Tamarack 4 S49W 15

August 17, 1989 Gary E. Koepke, PS "Set Cor. from traverse to be midway and on line between SW. Cor. Sec.33 (T42N-R14W) and 33 ft. south of the south line of "Old Deerfield First Addition" subdivision, and at a pro-rated G.L.O. distance between the SW.Cor. Sec.33 and the S.¼ Cor. Sec.36."

B. Description of corner evidence found and/or method applied in restoring or reestablishing corner:

Dec.20, 1999 Thomas P. O'Brien, PS recovered 1"x50" pipe w/inner sleeve & RLS cap on West side of blow down. Corner position verified by existing witnesses. East and West proportion checks well with proration noted in Section A. Reset 1" pipe with Schoolcraft County monument stamped to identify.

C. Description of monument for corner and accessories established to perpetuate locating the position of the corner:

Schoolcraft County monument
Witnesses:
10" Cedar s71°E 34.15'
Tin Pin N85°E 21.75'
10" Cedar East 35.90'
18" White Birch (dead stub) South 46.80'
8" Cedar S25°E 43.0'
Carsonite Post North 1.0'

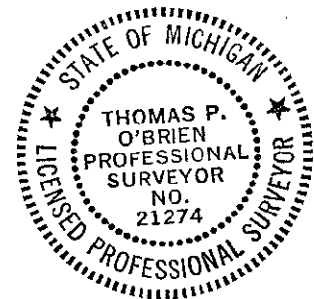

Thomas P. O'Brien

Signed by Thomas P. O'Brien
Surveyor's Michigan License No. 21274

Date Dec.30, 1999