

SCHOOLCRAFT COUNTY
PEER GROUP APPROVED

DATE 10/10/00 ODB

SURVEY &
REMONUMENTATION

FEB 08 2001

LAND CORNER RECORDATION CERTIFICATE
Filing Requirement of Act 74, Mich. P.A. 1970

SECTION

For corners in

<u>Schoolcraft</u> (County)	Located in:	Corner Code #
1. Public Land Survey	T 42NR 14W	H11
	T R	
	T R	
	T R	
2. Property Controlling in Section	S T R	
	S T R	
3. Miscellaneous Property in Sec.	S T R	
	S T R	

SIGRID HEDBERG 1P
SCHOOLCRAFT CO. REGISTER
Page 1 of 1 LC 4/387
JLV Date 12/19/2000 Time 11:53:28

Register of Deeds Stamp & File Number

4. Lot No. _____, Recorded Plat _____
5. Private Claims _____

I, Thomas P. O'Brien, in a field survey on 10/30/00 do hereby state that under requirements of P.A. 74, Michigan P.A. of 1970, the corner points mentioned in lines 1 and 2 above were in conformance with regulations and rules therefore as required in the current manual of survey instructions of the United States Department of the Interior, Bureau of Land Management or by a decree of a Court of Law and /or that the corner points mentioned in lines 3, 4 and 5 above were in conformance with the rules of the Michigan Board of Land Surveyors or by a Decree of a Court of Law; established, re-established, monumented, recovered, found as expressed below:

NOTE: Not more than 2 corners, all in the same town and range, may be recorded on this certificate.

	A	B	C	D	E	F	G	H	I	J	K	L	M
1													
2	6		5		4		3		2		1		
3													
4	7		8		9		10		11		12		
5													
6	10		17		16		15		14		13		
7													
8	19		20		21		22		23		24		
9													
10	30		29		28		27		26		25		
11													
12	31		32		33		34		35		36		
13													

A. Description of original monument and accessories and/or subsequent restoration:

April 3, 1851 Algernon Merryweather, DS set 1/4 post Cedar 12 in N50W 14 links
Cedar 14 in S69E 5 links

B. Description of corner evidence found and/or method applied in restoring or reestablishing corner:

Oct.30, 2000 Thomas P. O'Brien, PS found 1/2" iron bar with GSI 39091 cap. Corner checks well for single proportion G11 to I11. Accepted iron bar and replaced with Schoolcraft County monument.

C. Description of monument for corner and accessories established to perpetuate locating the position of the corner:

Schoolcraft County monument stamped to identify.

Witnesses:

10" Twin Cedar N31°E 17.32'

6" Cedar N36°W 39.07'

N.E. Corner House S46°W 66.05'

M.O. Curve S39°E 54.85'

Carsonite Post N5°E 1.0'

Thomas P. O'Brien

Signed by Thomas P. O'Brien

Surveyor's Michigan License No. 21274

Date Dec. 12, 2000

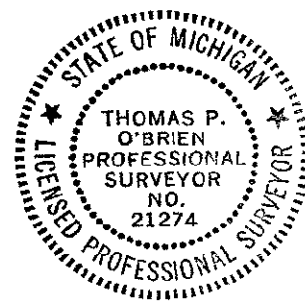

LIBER 4 PAGE: 387