

SCHOOLCRAFT COUNTY
PEER GROUP APPROVED

DATE 10/10/00 TPB

LAND CORNER RECORDATION CERTIFICATE
Filing Requirement of Act 74, Mich. P.A. 1970

SURVEY &
REMONUMENTATION

FEB 08 2001

For corners in

<u>Schoolcraft</u> (County)	Located In:	Corner Code #
1. Public Land Survey	T <u>42N</u> R <u>14W</u>	<u>I5</u>
	T ___ R ___	_____
	T ___ R ___	_____
	T ___ R ___	_____
2. Property Controlling in Section	S ___ T ___ R ___	_____
	S ___ T ___ R ___	_____
3. Miscellaneous Property in Sec.	S ___ T ___ R ___	_____
	S ___ T ___ R ___	_____

SIGRID HEDBERG 1P
SCHOOLCRAFT CO. REGISTER
Page 1 of 1 LC 4/399
JLV Date 12/19/2000 Time 11:53:36

SECTION

Register of Deeds Stamp & File Number

4. Lot No. _____, Recorded Plat _____
5. Private Claims _____

I, Thomas P. O'Brien, in a field survey on 11/6/00 ~~X99X~~ do hereby state that under requirements of P.A. 74, Michigan P.A. of 1970, the corner points mentioned in lines 1 and 2 above were in conformance with regulations and rules therefore as required in the current manual of survey instructions of the United States Department of the Interior, Bureau of Land Management or by a decree of a Court of Law and /or that the corner points mentioned in lines 3, 4 and 5 above were in conformance with the rules of the Michigan Board of Land Surveyors or by a Decree of a Court of Law; established, re-established, monumented, recovered, found as expressed below:

NOTE: Not more than 2 corners, all in the same town and range, may be recorded on this certificate.

A	B	C	D	E	F	G	H	I	J	K	L	M
1												
2	6		5		4		3		2		1	
3												
4	7		8		9		10		11		12	
5								X				
6	18		17		16		15		14		13	
7												
8	19		20		21		22		23		24	
9												
10	30		29		28		27		26		25	
11												
12	31		32		33		34		35		36	
13												

A. Description of original monument and accessories and/or subsequent restoration:

April 9, 1851 Algernon Merryweather, DS set post corner sections 10,11,14,15
Spruce 8 in N25E 8 links Spruce 7 in S45W 16 links

B. Description of corner evidence found and/or method applied in restoring or reestablishing corner:

Nov.6, 2000 Thomas P. O'Brien, PS found rotted post and point. Post point checks well with corners North and South. Replaced post point with Schoolcraft County monument. Old blazes N,S,E,W from post location.

C. Description of monument for corner and accessories established to perpetuate locating the position of the corner:

Schoolcraft County monument stamped to identify.

Witnesses:

- 6" Cedar N30°W 11.82'
- 10" Cedar S75°W 23.63'
- 4" Cedar S36°W 32.38'
- 8" Cedar N83°E 11.20'
- Carsonite Post South 1.0'

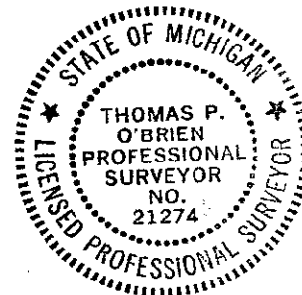

Thomas P. O'Brien
Signed by Thomas P. O'Brien

Date Dec.11, 2000

Surveyor's Michigan License No. 21274